

SPECIFICATIONS

Voltage Rating: 600V AC/DC (RMS)
 Current Rating: See table
 Contact Plating: Tin or Selective Gold
 Material: Nylon 66
 Withstanding: 1500V
 Temperature Range: -40C ~ 105C

Dimensions (mm)		
Circuits	A	B
2		0.213 (5.4)
4	0.165 (4.2)	0.378 (9.6)
6	0.331 (8.4)	0.543 (13.8)
8	0.496 (12.6)	0.709 (18.0)
10	0.662 (16.8)	0.874 (22.2)
12	0.827 (21.0)	1.039 (26.4)
14	0.993 (25.2)	1.205 (30.6)
16	1.158 (29.4)	1.370 (34.8)
18	1.324 (33.6)	1.535 (39.0)
20	1.489 (37.8)	1.701 (43.2)
22	1.655 (42.0)	1.866 (47.4)
24	1.820 (46.2)	2.031 (51.6)

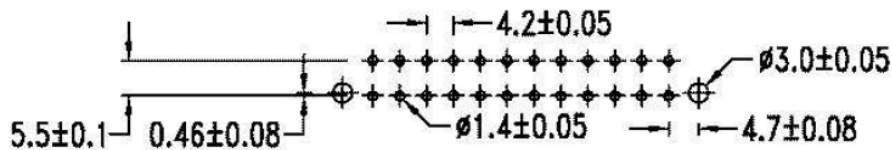

P.C.B. hole dimensions

AWG	Circuits			
	2	4~6	8~10	12~24
18	9A	8A	7A	6A
20	7A	6A	5A	5A
22	5A	4A	4A	4A
24	4A	3A	3A	3A

Series	Type	Positions	Options	Plating
JS-A	9359	XX	XX	XX
Pluggable Connector	Vertical Header	02-24 Dual Row	Blank=None	Blank=Tin (Std)
	9359=Dual Row	02-12 Single Row	P=Centering Pegs	GD=Gold
	9359S=Single Row		D=Drain Holes	
			PD=Peg & Drain Holes	

RoHS compliant

Rev.	Description	Date	Approved	Drawing	Name	Date
				Approved	Howard	02/29/08
				Checked	Lizzy	02/29/08
				Drawn	Tina	02/29/08
				0.0 ± 0.35	0.00 ± 0.20	Angles ± 3'
				UNIT: mm		

Central Components Manufacturing
 440 Lincoln Blvd., Middlesex, New Jersey 08846
 Phone 732 469-5720 888 288-5152 Fax 732 469-1919

Part No.: **JS-A-9359-XX-PD-XX**

Description: .165" Mini Fit Straight Header

