

Surface Mount Type 1

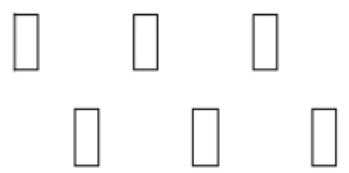

Recommended PCB Layout

SPECIFICATIONS

- Current Rating: 2 A
- Contact Material: Phos. Bronze
- Contact Resistance: 20 milliohms max.
- Contact Plating: Gold Flash Standard
See Plating Options
- Insulator Resistance: 1000 Megohms min.
- Insulator Material: Nylon 6T, UL 94V-0
- Withstanding: 500 VAC
- Operating Temp: -40°C to +105°C

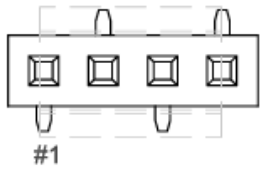

Surface Mount Type 2

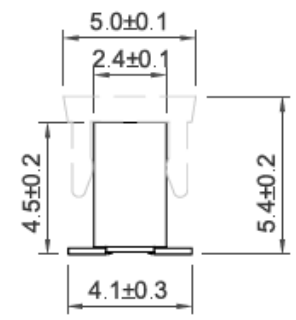
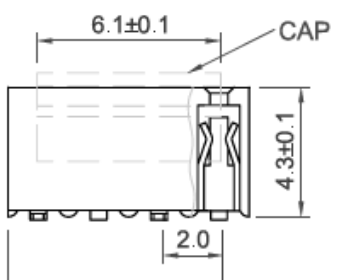
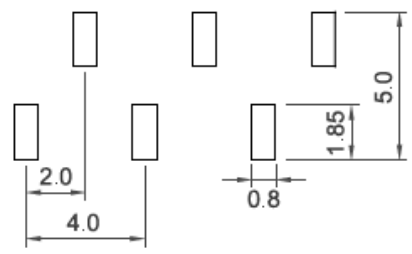

2.0 X No. of Contacts - 2.0 ± 0.25

Series	Rows	Contacts	Plating	Options	Packaging
BRS	0X	XX	XX	SMX	XX
2mm Receptacle strip	01=Single 02=Dual	Single row 1-40 Dual row 2-80	TN=Tin SGXX=Selective gold GDXX=Gold XX=Flash if blank, 10, 15, 30µ"	SM1=Surface mount type 1 SM2=Surface mount type 2	TB=Tube BM=TB+Metal Cap RM=Reel+Metal Cap BP=TB+Plastic Cap RP=Reel+Plastic Cap BF=Tube+Film RF=Reel+Film

RoHS compliant

Rev.	Description	Date	Approved	Drawing	Name	Date
				Approved	Howard	10/21/08
				Checked	Lizzy	10/21/08
				Drawn	Tina	10/21/08
				0.0 ± 0.35	0.00 ± 0.20	Angles ± 3'
				UNIT: mm		

Central Components Manufacturing
 440 Lincoln Blvd., Middlesex, New Jersey 08846
 Phone 732 469-5720 888 288-5152 Fax 732 469-1919

Part No.: **BRS-01-XX-XX-SMX-XX**
 Description: Receptacle strip, single row, .079" (2.00mm) pitch, top entry, three point contact redundancy