

Recommended P.C.Board

SMD Layout

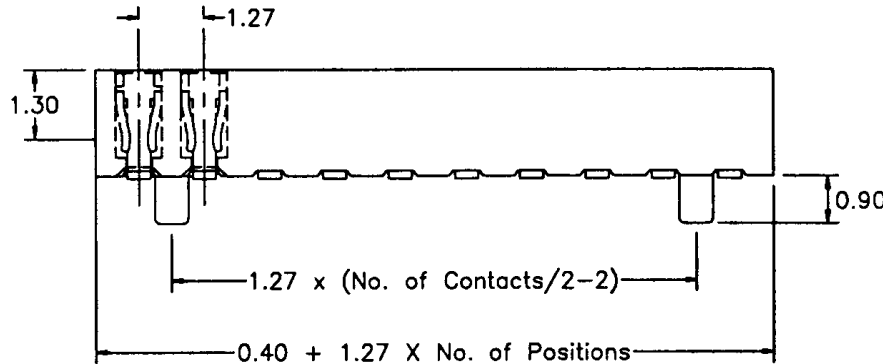
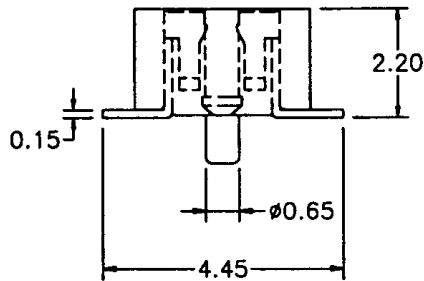
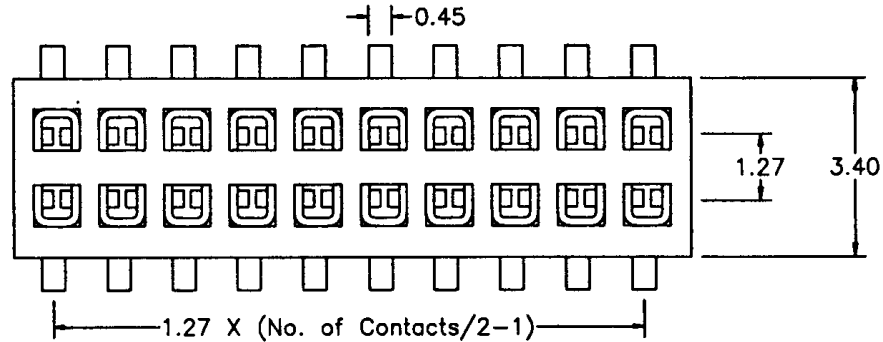
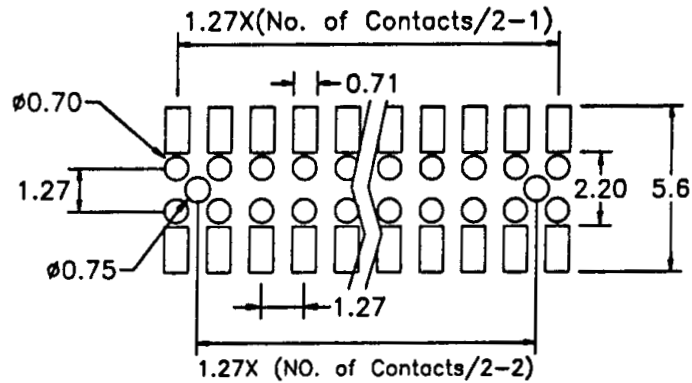

SPECIFICATIONS

Current rating:	1.75 amps
Contact material:	Phosphor bronze
Contact plating:	Gold
Insulator material:	Polyester (Nylon-6T), UL94V-0
Insulator resistance:	5,000 megohms min.
Contact resistance:	20 milliohms max.
Withstanding:	500VAC for 1 min.
Operating temperature:	-40°C to +105°C
Processing temperature:	230°C for 30 sec. max.

RoHS compliant

Rev.	Description	Date	Approved	Drawing	Name	Date
				Approved	Howard	02/10/00
				Checked	Lizzy	02/10/00
				Drawn	Tina	02/10/00
				0.0 ± 0.35	0.00 ± 0.20	Angles ± 3'
						UNIT: mm

Central Components Manufacturing
 440 Lincoln Blvd., Middlesex, New Jersey 08846
 Phone 732 469-5720 888 288-5152 Fax 732 469-1919

Part No.: **CRS-02LDE-XX-XX-SM**

Description: Receptacle strip, low profile, dual entry, SMT