

SPECIFICATIONS

Current rating: 5 amps max.
 Voltage rating: 500VDC
 Contact material: Phosphor bronze
 Contact plating: Contacts, gold over nickel
 Solder pins, gold flash
 Contact resistance: 20 milliohms max.
 Insulator material: Polybutylene Terephthalate (PBT), glass reinforced, UL94V-0
 Insulation resistance: 1,000 megohms min. at 1,000VAC
 Shell material: Steel, tin plated
 Capacitance: 2 pF max between adjacent contacts
 Operating temperature: -50°C to +100°C

09P-DIMPLEDx3
 15P-DIMPLEDx5
 25P-DIMPLEDx8
 37P-DIMPLEDx12

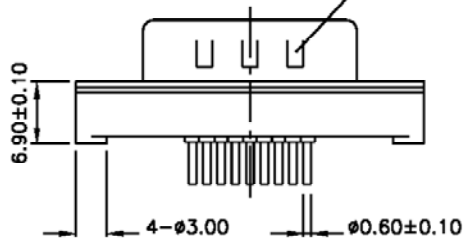

PCB LAYOUT

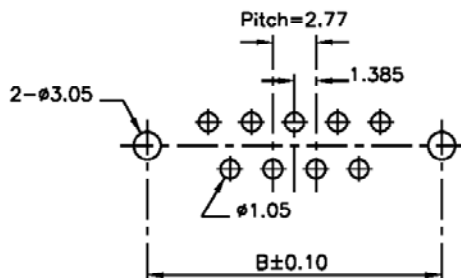

Dimensions in (mm)			
Pos.	A	B	C
9	1.213 (30.80)	0.984 (24.99)	0.666 (16.92)
15	1.541 (39.15)	1.312 (33.32)	0.994 (25.25)
25	2.087 (53.00)	1.852 (47.04)	1.534 (38.96)
37	2.728 (69.30)	2.500 (63.50)	2.182 (55.42)

RoHS compliant

Series	Type	Tail	Mounting Face Options
DSXX	SXXX	A	XX
D-sub connector XX=Pins 09, 15, 25, 37	SMT=Flush mount male SFT=Flush mount female SMTA=High profile male SFTA=High profile female	Standard	01=.120" thru holes 02=#4-40 threaded inserts 03=Inserts and board locks 04=Jackscrews 05=Jackscrews and board locks

Rev.	Description	Date	Approved	Drawing	Name	Date
				Approved	Howard	08/10/99
				Checked	Lizzy	08/10/99
				Drawn	Tina	08/10/99
				0.0 ± 0.35	0.00 ± 0.20	Angles ± 3'
				UNIT: mm		

Central Components Manufacturing
 440 Lincoln Blvd., Middlesex, New Jersey 08846
 Phone 732 469-5720 888 288-5152 Fax 732 469-1919

Part No.: **DSXX-SMT-A-01**

Description: D-sub connector, flush mount, male, through holes