

PCB LAYOUT

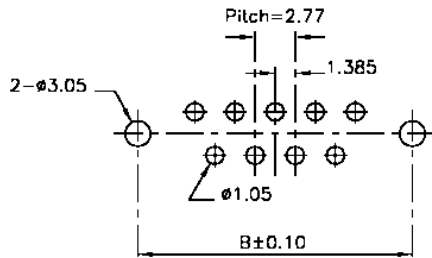

SPECIFICATIONS

| | |
|------------------------|---|
| Current rating: | 5 amps max. |
| Voltage rating: | 500VDC |
| Contact material: | Phosphor bronze |
| Contact plating: | Gold over nickel in contact area Gold flash on solder pins |
| Contact resistance: | 20 milliohms max. |
| Insulator material: | Polybutylene Terephthalate (PBT) Glass reinforced, UL94V-0 |
| Insulation resistance: | 1,000 megohms min. at 1,000 volts AC |
| Shell material: | Steel |
| Shell plating: | Tin |
| Capacitance: | 2 pF max between adjacent contacts |
| Operating temperature: | -50°C to +100°C |

| Dimensions in/(mm) | | | |
|--------------------|---------------|---------------|---------------|
| Pos. | A | B | C |
| 9 | 1.213 (30.80) | 0.984 (24.99) | 0.642 (16.30) |
| 15 | 1.541 (39.15) | 1.312 (33.32) | 0.970 (24.65) |
| 25 | 2.087 (53.00) | 1.852 (47.04) | 1.512 (38.40) |
| 37 | 2.728 (69.30) | 2.500 (63.50) | 2.157 (54.80) |

| Series | Type | Tail | Mounting Face Options |
|--|--|----------|--|
| DSXX | SXXX | A | XX |
| D-sub connector XX=Pins 09, 15, 25, 37 | SMT=Flush mount male SFT=Flush mount female SMTA=High profile male SFTA=High profile female | Standard | 01=.120" thru holes 02=#4-40 threaded inserts 03=Inserts and board locks 04=Jackscrews 05=Jackscrews and board locks |

RoHS compliant

| Rev. | Description | Date | Approved | Drawing | Name | Date |
|------|-------------|------|----------|------------|-------------|-------------|
| | | | | Approved | Howard | 08/10/99 |
| | | | | Checked | Lizzy | 08/10/99 |
| | | | | Drawn | Tina | 08/10/99 |
| | | | | 0.0 ± 0.35 | 0.00 ± 0.20 | Angles ± 3' |
| | | | | UNIT: mm | | |

Central Components Manufacturing
 440 Lincoln Blvd., Middlesex, New Jersey 08846
 Phone 732 469-5720 888 288-5152 Fax 732 469-1919

Part No.: **DSXX-SFT-A-02**

Description: D-sub connector, flush mount, female, threaded inserts