

SPECIFICATIONS

Current Rating: 3 Amps
 Withstanding: AC 500V
 Insulation Resistance: 1000 Megohms Min
 Contact Resistance: 30 Milliohms Max
 Contact Material: Copper Alloy
 Insulator Material: PBT
 Shell Material: SPCC
 Z-Piece: Fe
 Screw: Copper Alloy
 Rivet: Copper Alloy or Zinc
 Operating Temp: -55C to 105C

Recommend PCB Layout

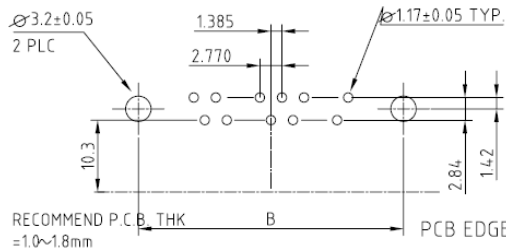
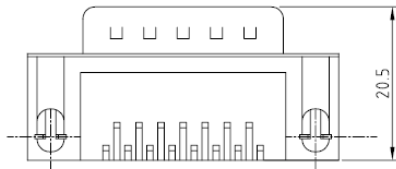

Dimensions mm (in)			
Pins	A	B	C
9	16.92	24.99	30.81
15	25.25	33.32	39.14
25	38.96	47.04	53.04
37	55.42	63.50	69.32

Series	Type	PCB Mounting Options	Mounting/Face Options	Special Options
DSXX	XR4	X (diagrams pg. 2)	X (diagrams pg. 3)	XX
D-sub connector XX=Pins 09, 15, 25, 37, 50	MR4=Male FR4=Female	1=Wraparound ground straps with screw holes 2=Top side only ground straps with #4-40 threaded screw holes 3=Forked board locks 4=Top side only ground straps with screw holes	A=#4-40 fixed jack screws B=#4-40 threaded inserts C=#4-40 threaded inserts w/ jackscrews installed CN=Inserts w/ Jackscrews Separate D=.120" non-threaded through holes	[blank]=None XXGD=Gold plate XX=Flash if blank, 3,5,10,15,30u"

RoHS compliant

Rev.	Description	Date	Approved	Drawing	Name	Date
				Approved	Howard	10/10/05
				Checked	Lizzy	10/10/05
				Drawn	Tina	10/10/05
				0.0 ± 0.35	0.00 ± 0.20	Angles ± 3'
				UNIT: mm		

Central Components Manufacturing
 440 Lincoln Blvd., Middlesex, New Jersey 08846
 Phone 732 469-5720 888 288-5152 Fax 732 469-1919

Part No.: **DSXX-MR4-23-C**

Description: D-subminiature connector, 0.406" foot print, right angle, male, PCB mount