

**SPECIFICATIONS**

Current rating: 5 amps  
 Voltage rating: 500VAC  
 Contact resistance: 15 milliohms max.  
 Insulation resistance: 1,000 megohms min.  
 Shell material: Steel  
 Shell plating: Tin or chromate  
 Insulator option 1: PBT+30% glass fiber, UL94V-0  
 Insulator option 2: Nylon 66, UL94V-0  
 Insulator color: Black  
 Operating temperature: -50°C to +100°C

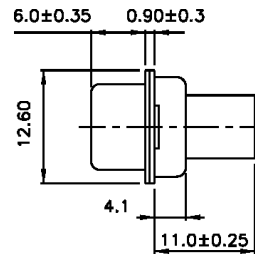
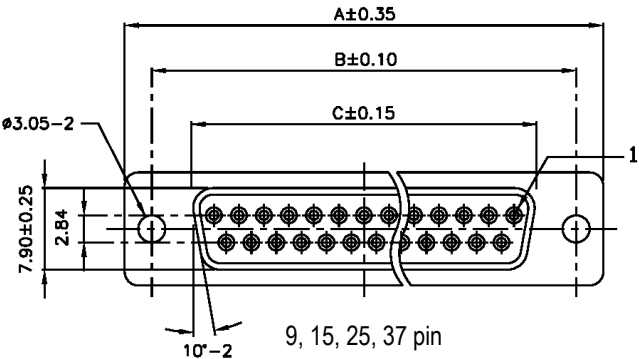

Dimensions			
Pins	A	B	C
9	30.80	24.99	16.30
15	39.15	33.32	24.65
25	53.00	47.04	38.40
37	69.30	63.50	54.80
50	67.00	61.00	52.20

RoHS compliant

Series	Gender	Mounting Face	Options
DSXX	XCP	XXX	XX
D-Sub connector XX=Pins 09, 15, 25, 37, 50	MCP=Male FCP=Female	[blank]=.120" through hole RCN=Riveted clinch nut #4-40 RJS=Riveted jackscrew #4-40	[blank]=None YC=Yellow chromate 30GD=30μ" gold plate

Rev.	Description	Date	Approved	Drawing	Name	Date
				Approved	Howard	08/10/99
				Checked	Lizzy	08/10/99
				Drawn	Tina	08/10/99
				0.0 ± 0.35	0.00 ± 0.20	Angles ± 3'
				UNIT: mm		

**Central Components Manufacturing**  
 440 Lincoln Blvd., Middlesex, New Jersey 08846  
 Phone 732 469-5720 888 288-5152 Fax 732 469-1919

Part No.: **DSXX-FCP-XXX-XX**

Description: D-Subminiature connector, crimp housing type, female