

**SPECIFICATIONS**

Current rating: 5 amps  
 Voltage rating: 500VAC  
 Contact material: Brass, stamped pin  
 Contact plating: Gold over nickel  
 Contact resistance: 15 milliohms max.  
 Shell material: Steel  
 Shell plating: Tin or chromate plated  
 Insulator material: PBT + fiber-glass, UL94V-0  
 Insulation resistance: 1,000 megohms min.  
 Withstanding: 1,000VAC for 1 min.  
 Durability: 500 insertion/separation cycles min.  
 Temperature range: -55°C to +105°C

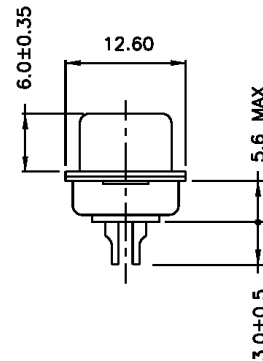
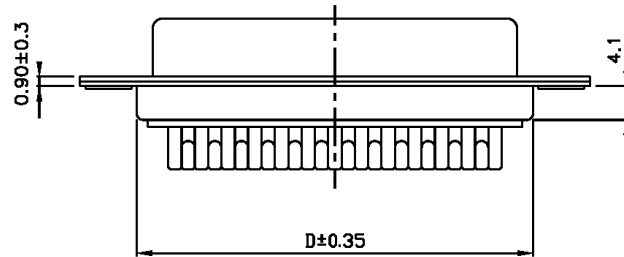

Dimensions (mm)				
Pins	A	B	C	D
9	30.80	24.99	16.30	19.20
15	39.15	33.32	24.65	27.70
25	53.00	47.04	38.40	41.10
37	69.30	63.50	54.80	57.30

Series	Gender	Mounting Options	Special Options
DSXX	XC	XXX	XX
D-sub connector XX=Pins 09, 15, 25, 37	MC=Male FC=Female	[blank]=.120" through holes RCN=Riveted clinch nuts #4-40 RJS=Riveted jackscrews #4-40	[blank]=None YC=Yellow chromate 30GD=30µ" gold plate on contact

RoHS compliant

Rev.	Description	Date	Approved	Drawing	Name	Date
				Approved	Howard	08/10/99
				Checked	Lizzy	08/10/99
				Drawn	Tina	08/10/99
				0.0 ± 0.35	0.00 ± 0.20	Angles ± 3'
				UNIT: mm		

**Central Components Manufacturing**  
 440 Lincoln Blvd., Middlesex, New Jersey 08846  
 Phone 732 469-5720 888 288-5152 Fax 732 469-1919

Part No.: **DSXX-FC-XXX-XX**

Description: D-subminiature connector, solder type, stamped pin, female