

**SPECIFICATIONS**

Voltage rating: 600VDC max.  
 Current rating: 5 amps max.  
 Contact material: Phosphor bronze, stamped and formed  
 Contact resistance: 8 milliohms max.  
 Plating, contacts: 5µ" gold (30µ" optional) MIL-G-45204 type 2 grade C over 50µ" nickel QQ-N-290 class 2 grade C  
 Plating, solder tails: Gold flash  
 Shell material: Steel, tin or chromate plated  
 Insulator material: PBT, glass reinforced, UL94V-0  
 Insulation resist.: 5,000 megohms min.  
 Withstanding: 1,000VAC RMS min.  
 Cycle life: 500 cycles min.  
 Insertion force: 10oz. max. (.041" pin)  
 Withdrawal force: 7.1oz. min. (.039" pin)  
 Operating temp.: -55°C to +125°C

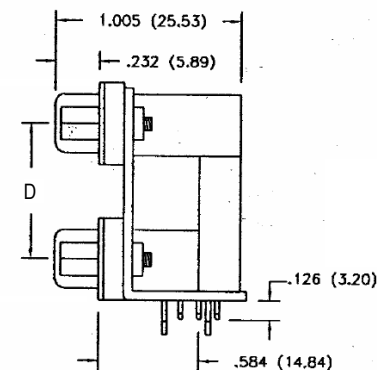
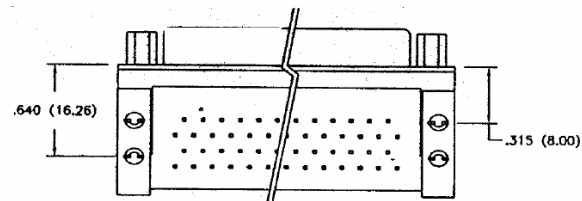
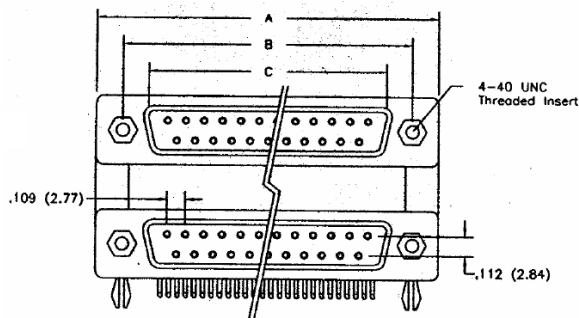

Pins	A	B	C(F)	C(M)
9	30.81	24.99	16.33	16.92
15	39.14	33.32	24.66	25.25
25	53.04	47.04	38.38	38.96
37	69.32	63.50	54.84	55.42

Series	Gender	Port Spacing	Mounting/Face Options	Options
DSXX	XX	X (D)	XX	XX
D-sub connector XX=Pins 09, 15, 25, 37 XX/XX=mixed	Top then bottom MF=Male, female MM=Male, male FF=Female, female FM=Female, male	A=0.625 B=0.750 C=0.900	01=0.120 thru-holes 02=#4-40 threaded thru-holes 03=#4-40 threaded inserts with jack screws installed 04=Forked board locks 04S=Rear board locks only 04F=Front board locks only	[blank]=None GD15=15µ" gold on mating area GD30=30µ" gold on mating area

**RoHS compliant**

Rev.	Description	Date	Approved	Drawing	Name	Date
				Approved	Howard	04/10/98
				Checked	Lizzy	04/10/98
				Drawn	Tina	04/10/98
				0.0 ± 0.35	0.00 ± 0.20	Angles ± 3'
				UNIT: mm		

**Central Components Manufacturing**  
 440 Lincoln Blvd., Middlesex, New Jersey 08846  
 Phone 732 469-5720 888 288-5152 Fax 732 469-1919

Part No.: **DSDXX-XX-X-XX-XX**

Description: D-sub connector, 0.318" right angle male, PCB mount, ferrite filter