

**SPECIFICATIONS**

Current rating:	3 amps
Contact material:	Brass
Contact resistance:	25 milliohms max.
Insulator material:	PBT + 30% glass fill, UL97V-0
Insulation resistance:	5,000 megohms min. at 500 VDC
Shell material:	Steel
Withstanding:	1,000 VAC for 1 min.
Insertion force:	300gf max.
Withdrawal force:	25gf min.
Operating temperature:	-55°C to +105°C

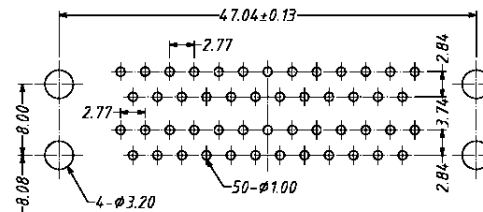
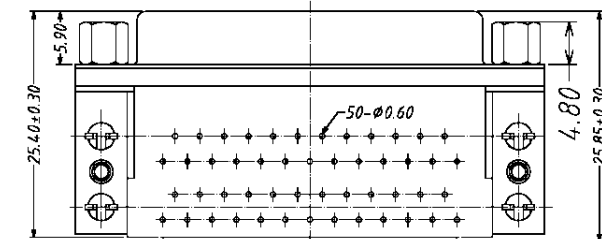

PC Board Layout

Series	Configuration	Port Spacing	Mounting Options	Options
DSDXX	FF	X	XX	XX
Stacked D-sub connector XX=Upper positions YY=Lower positions (Omitted if same as upper)	MM=Male over male FF=Female over female MF=Male over female FM=Female over male	A=.625" B=.750" C=.900"	01=.120" thru holes 02=#4-40 threaded holes 03=Threaded holes with jackscrews 04=Boardlocks, front and rear 04S=Boardlocks, rear only 04F=Boardlocks, front only	[blank]=None FF=Ferrite filtered 30GD=30µ" gold 15GD=15µ" gold

RoHS compliant

Rev.	Description	Date	Approved	Drawing	Name	Date
				Approved	Howard	08/10/04
				Checked	Lizzy	08/10/04
				Drawn	Tina	08/10/04
				0.0 ± 0.35	0.00 ± 0.20	Angles ± 3'
				UNIT: mm		

**Central Components Manufacturing**  
 440 Lincoln Blvd., Middlesex, New Jersey 08846  
 Phone 732 469-5720 888 288-5152 Fax 732 469-1919

Part No.: **DSD25-FF-B-0304-FF**

Description: D-subminiature connector, stacked, filtered, 25-pin female over 25-pin female