

**SPECIFICATIONS**

Current rating:	3 amps
Contact material:	Brass
Contact resistance:	25 milliohms max.
Insulation material:	PBT + 30% glass fiber, UL94V-0
Insulation resistance:	5,000 megohms min at 500VDC
Shell material:	Steel
Withstanding:	1,000VAC for 1 min.
Insertion force:	300gf max.
Separation force:	25gf min.
Operating temperature:	-55°C to +105°C

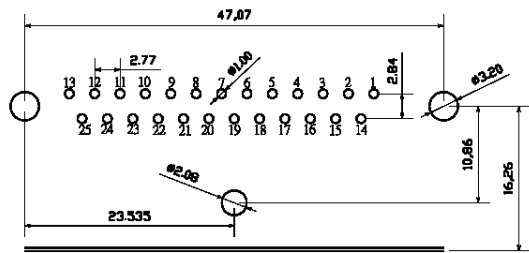
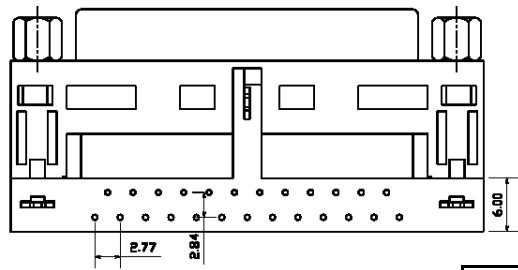

RECOMMENDED PCB LAYOUT

Series	Gender	Port Spacing	Mounting Face Options	Options
DSDXX/YY	XX	X	X	XX
Dual-port D-sub XX=Upper position YY=Lower position (Omit if same as upper)	MM=Male over male MF=Male over female FM=Female over male FF=Female over female FMF=Female over male-female	A=.625" B=.750" C=.900"	01=.120" thru hole 02=#4-40 threaded hole 03=#4-40 threaded insert w/jackscrew 04=Boardlocks, front and rear 04S=Boardlocks, rear only 04F=Boardlocks, front only	[blank]=None FF=Ferrite filter 30GD=30µ" gold plate 15GD=15µ" gold plate

RoHS compliant

Rev.	Description	Date	Approved	Drawing	Name	Date
				Approved	Howard	08/10/99
				Checked	Lizzy	08/10/99
				Drawn	Tina	08/10/99
				0.0 ± 0.35	0.00 ± 0.20	Angles ± 3'
				UNIT: mm		

**Central Components Manufacturing**  
 440 Lincoln Blvd., Middlesex, New Jersey 08846  
 Phone 732 469-5720 888 288-5152 Fax 732 469-1919

Part No.: **DSD25/0-F-A-0304**  
 Description: D-subminiature connector, stacked, 25P male over blank, #4-40 threaded holes, board locks front and rear