

SPECIFICATIONS

Current Rating:	5 Amps
Voltage Rating:	500V AC for 1 minute
Contact Material:	Copper
Contact Plating:	Gold Plating over Nickel
Contact Resistance:	15 m Ohms Max
Insulation Material:	PBT + Fibre-Glass, UL94V-0, black
Shell Material:	Steel, Tin Plated
Insulator Resistance:	1000 M Ohms min
Spacer Material:	PBT + Fibre-Glass, UL94V-0, black
Rivet Material:	Brass, Nickel or Tin Plating
Temperature Range:	-50°C to +100°C

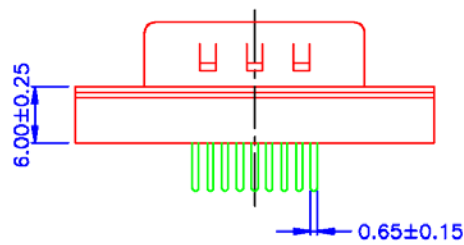

Recommended PCB Layout

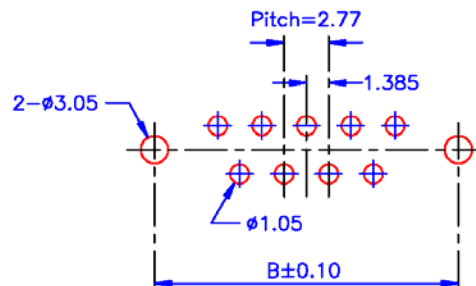

Dimensions			
Pins	A	B	C
09	30.80	24.99	16.92
15	39.15	33.32	25.25
25	53.00	47.04	38.96
37	69.30	63.50	55.42

RoHS compliant

Rev.	Description	Date	Approved	Drawing	Name	Date
				Approved	Howard	08/19/09
				Checked	Lizzy	08/19/09
				Drawn	Tina	08/19/09
				0.0 ± 0.35	0.00 ± 0.20	Angles ± 3'
					UNIT: mm	

Central Components Manufacturing
 440 Lincoln Blvd., Middlesex, New Jersey 08846
 Phone 732 469-5720 888 288-5152 Fax 732 469-1919

Part No.: **DS09-SMT-A-02**

Description: DD-Series Male/Plug 02 Type without Standoffs w/ Threaded inserts