

SPECIFICATIONS

Current Rating: 5 Amps
 Voltage Rating: 500V AC for 1 minute
 Contact Material: Brass, Gold Plating over Nickel
 Contact Resistance: 15 mΩ Max.
 Insulation Material: PBT+Fiber-Glass, UL94V-0, Black
 Insulation Resistance: 1000 MΩ Min
 Shell Material: Steel, Tin Plated
 Spacer Material: PBT + Fiber-Glass, UL94V-0, Black
 Rivet Material: Brass, Nickel Plated
 Temperature Range: -50°C to +100°C

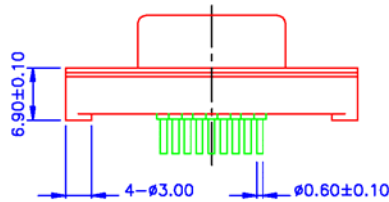

Recommended PC-Board Layout

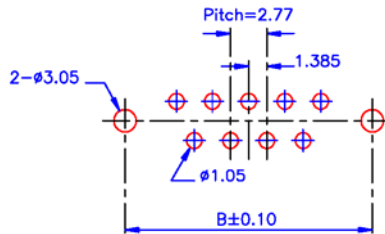

Dimensions			
Pos	A	B	C
09	30.80	24.99	16.30
15	39.15	33.32	24.65
25	53.00	47.04	38.40
37	69.30	63.50	54.80

Series	Type	Tail	Mounting Face Options
DSXX	SXXX	A	XX
D-sub connector XX=Pins 09, 15, 25, 37	SMT=Flush mount male SFT=Flush mount female SMTA=High profile male SFTA=High profile female	Standard	01=.120" thru holes 02=#4-40 threaded inserts 03=Inserts and board locks 04=Jackscrews 05=Jackscrews and board locks

RoHS compliant

Rev.	Description	Date	Approved	Drawing	Name	Date
				Approved	Howard	06/24/03
				Checked	Lizzy	06/24/03
				Drawn	Tina	06/24/03
				0.0 ± 0.35	0.00 ± 0.20	Angles ± 3'
				UNIT: mm		

Central Components Manufacturing
 440 Lincoln Blvd., Middlesex, New Jersey 08846
 Phone 732 469-5720 888 288-5152 Fax 732 469-1919

Part No.: **DS09-SFTA-A-01**

Description: DD-Series, Female With Thread Insert