

SPECIFICATIONS

Connector
 Coupling: Threaded
 Shell Material: Nylon66, V-0
 Insert Material: PPS 260C max, V-0
 Contact Material: Brass, Gold Plating
 Termination: solder/crimp
 Cable OD: 6-10mm
 IP Rating: IP68
 Mating Cycles: ≥500
 Temperature Range: -25C ~ +85C
 Insulation Resistance: 2000
Overmold
 Coupling: Threaded
 Shell Material: PC, PVC, V-0
 Anodized Aluminum Nut
 Insert Material: PPS 260C max, V-0
 Contact Material: Brass, Gold Plating
 IP Rating: IP66
 Mating Cycles: ≥500
 Temperature Range: -20C ~ +85C
 Insulation Resistance: 2000

Series	Type	Male/Female
CWP	SP-17XX	X
Circular Waterproof Connector	XX= See Dwg.	P=Male Plug S=Female Socket PC=Plug w/ Cover SC=Socket w/ Cover

Positions	Cable Diam.
XX	X
02-10 See Chart	(SP-1710, SP-1711) A=6-10mm

Insert Configuration, Female Face View (2,3,4 for crimp contact)							
Configuration							
Part # (CWP-SP-17XX-X-XX)	02	03	04	05	07	09	10
Current Rating	10A	10A	5A	5A	5A	5A	5A
Size & No. Contacts	Ø1.5X2	Ø1.5X3	Ø1X4	Ø1X5	Ø1X7	Ø1X9	Ø1X10
Rated Voltage	500V	500V	500V	500V	400V	400V	400V
Test Voltage	1500V	1500V	1500V	1500V	1200V	1200V	1200V
Contact Resistance mΩ	2.5	2.5	5	5	5	5	5
Wire Size mm ² /AWG	≤2/14	≤2/14	≤0.785/18	≤0.785/18	≤0.785/18	≤0.785/18	≤0.785/18

RoHS compliant

Rev.	Description	Date	Approved	Drawing	Name	Date
				Approved	Howard	02/02/10
				Checked	Lizzy	02/02/10
				Drawn	Tina	02/02/10
				0.0 ± 0.35	0.00 ± 0.20	Angles ± 3'
					UNIT: mm	

Central Components Manufacturing
 440 Lincoln Blvd., Middlesex, New Jersey 08846
 Phone 732 469-5720 888 288-5152 Fax 732 469-1919
 Part No.: **CWP-SP-17XX-X-XX-X**
 Description: Circular Waterproof Connector



CWP-SP-1710-P



CWP-SP-1710-S

This item mates with
CWP-SP-1711, CWP-SP-1712
Threaded Coupling
Solder Termination

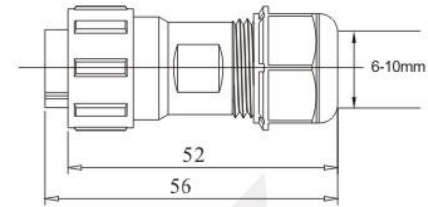
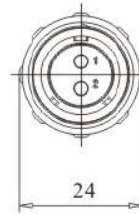

CWP-SP-1711-P



CWP-SP-1711-S

This item mates with
CWP-SP-1710
Threaded Coupling
Solder Termination

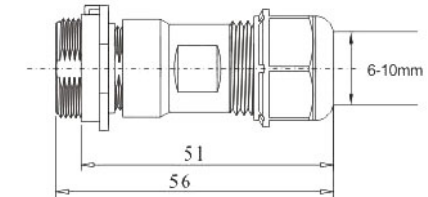
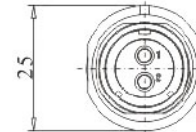

CWP-SP-1712-P



CWP-SP-1712-S

This item mates with
CWP-SP-1710
Threaded Coupling
Solder Termination

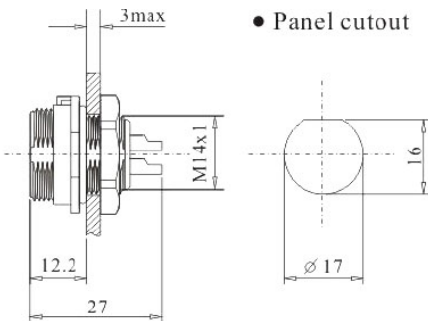
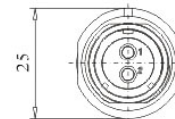

Rev.	Description	Date	Approved	Drawing	Name	Date
				Approved	Howard	02/02/10
				Checked	Lizzy	02/02/10
				Drawn	Tina	02/02/10
				0.0 ± 0.35	0.00 ± 0.20	Angles ± 3'
				UNIT: mm		

Central Components Manufacturing
 440 Lincoln Blvd., Middlesex, New Jersey 08846
 Phone 732 469-5720 888 288-5152 Fax 732 469-1919

Part No.: **CWP-SP-17XX-X-XX-X**

Description: Circular Waterproof Connector