

	A
6P2C	5.20
6P4C	5.20
6P6C	7.15

**SPECIFICATIONS**

Contact: Copper Alloy  
 Plating: Gold Plating  
 Housing: PC UL94V-2 (UL94V-0)

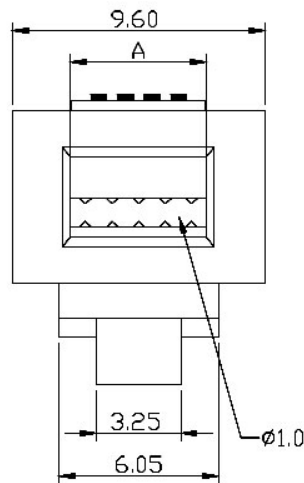
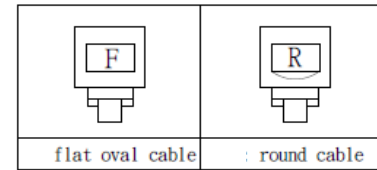

**Contact blade (A or B )**

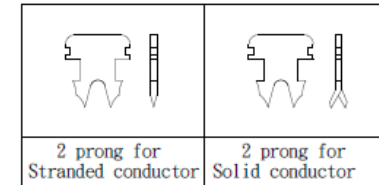

**Others**

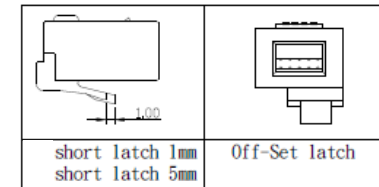

Series	Plug Size	Contacts	Type	Plating	Options
CTP	XX	X	XXXX	PX	XX
Modular plug	4, 6, 8, 10	2, 4, 6, 8, 10	Type=100	P1=15μ" gold P2=30μ" gold P3=50μ" gold	[blank]=Flat Stranded Wire RW=Round wire SW=Solid wire MS=Metal Shield

**RoHS compliant**

Rev.	Description	Date	Approved	Drawing	Name	Date
				Approved	Howard	01/02/14
				Checked	Lizzy	01/02/14
				Drawn	Tina	01/02/14
				0.00 ± 0.01 0.000 ± .005	Angles ± 1°	
					UNIT: mm	

**Central Components Manufacturing**  
 440 Lincoln Blvd., Middlesex, New Jersey 08846  
 Phone 732 469-5720 888 288-5152 Fax 732 469-1919

Part No.: **CTP-06-4-100-PX-XX**

Description: 6 Position Modular Plug, Short Body Style