

SPECIFICATIONS

Contact material: Phosphor bronze alloy 0.35 mm
 Contact plating: Hard gold on contact area
 Tin on tail area
 Housing material: Thermoplastic UL94V-0
 Shield material: Brass
 Shield plating: Nickel

PCB LAYOUT/TOP VIEW

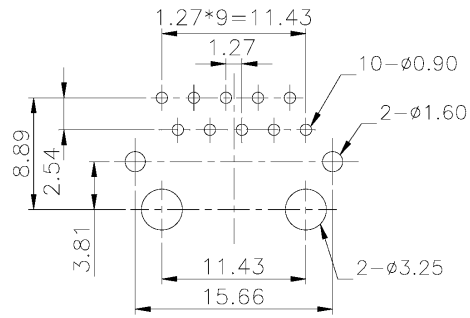

Series	Positions	Contacts	Style	Color	Plating	Options
CTJ	X	XX	DRHP	BK	PX	XX
Modular jack	4,6,8, 10	2,4,6,8, 10	D Style with Reversed Layout and Half Peg	BK=Black	P1=15μ" gold P2=30μ" gold P3=50μ" gold	[blank]=Flange WF=No flange KY=Keyed FS=Full shield

RoHS compliant

Rev.	Description	Date	Approved	Drawing	Name	Date
				Approved	Howard	08/10/99
				Checked	Lizzy	08/10/99
				Drawn	Tina	08/10/99
				0.0 ± 0.35	0.00 ± 0.20	Angles ± 3'
				UNIT: mm		

Central Components Manufacturing
 440 Lincoln Blvd., Middlesex, New Jersey 08846
 Phone 732 469-5720 888 288-5152 Fax 732 469-1919

Part No.: **CTJ-10-10-DRHP-BK-PX-FS**

Description: Modular jack, top entry, shielded

