

Grounding feet options

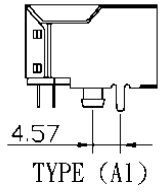

TYPE (A1)

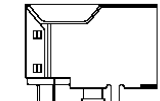

TYPE (B1)

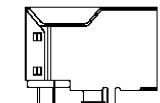

TYPE (C1)

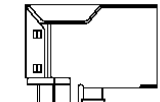

TYPE (D1)  
Rear 3.05

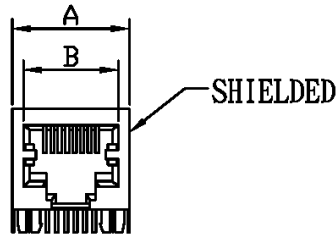

SHIELDED

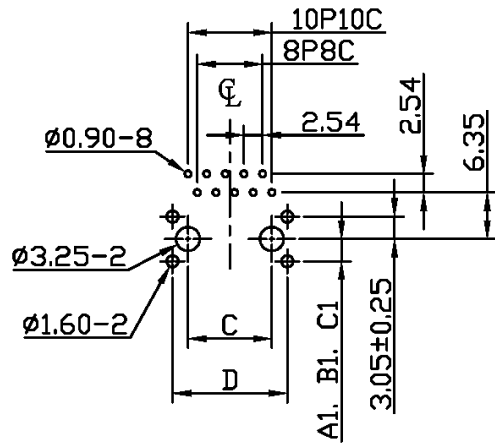
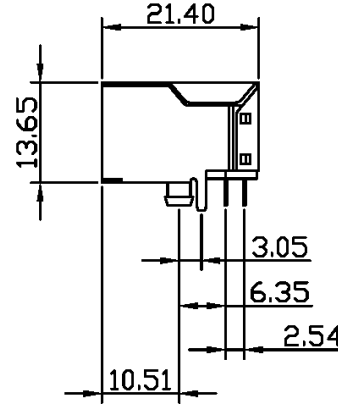

PC Board Layout

Panel grounding options

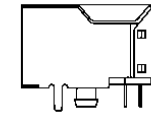

W0/P. G. Tab

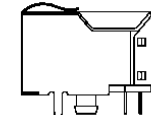

Top P. G. Tab

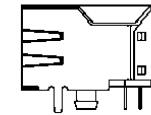

Side P. G. Tab

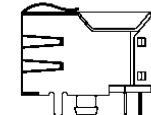

Top & Side P. G. Tab

SPECIFICATIONS

- Contact material: Phosphor bronze
- Contact plating: Gold
- Housing material: PBT with 15% glass fiber, UL94V-0
- Shield material: Copper alloy 0.25mm
- Shield plating: Nickel

Dimensions					
Pos.	Con.	A	B	C	D
6	2,4,6	14.00	9.90	10.16	13.50
8	4,6,8	16.00	11.93	11.43	15.49
10	10	16.00	11.93	11.43	15.49

Series	Positions	Contacts	Body	Ground Tab	Color	Plating	Options	Panel Grounds
CTJ	X	XX	H	XX	BK	PX	FS	PGX
Modular phone jack	6, 8, 10	02, 04, 06, 08, 10	H=Side entry, bottom tab	A1, B1, C1, D1 (see diagrams)	BK=Black	P1=15µ" gold P2=30µ" gold P3=50µ" gold	FS=Full shield	[omitted]=None 4=Sides 1=Top (single) 6=Top & sides 2=Top (see diagrams)

RoHS compliant

Rev.	Description	Date	Approved	Drawing	Name	Date
				Approved	Howard	03/18/03
				Checked	Lizzy	03/18/03
				Drawn	Tina	03/18/03
				0.0 ± 0.35	0.00 ± 0.20	Angles ± 3'
				UNIT: mm		

**Central Components Manufacturing**  
 440 Lincoln Blvd., Middlesex, New Jersey 08846  
 Phone 732 469-5720 888 288-5152 Fax 732 469-1919

Part No.: **CTJ-8-08-H-XX-BK-PX-FS-PGX**

Description: Modular jack, 8P8C, full shield