

**SPECIFICATIONS**

Housing material: Polyester, UL94V-0, glass filled, gray or black  
 Contact material: Phosphor bronze,  $\phi 0.46\text{mm}$   
 Contact plating: Gold over nickel

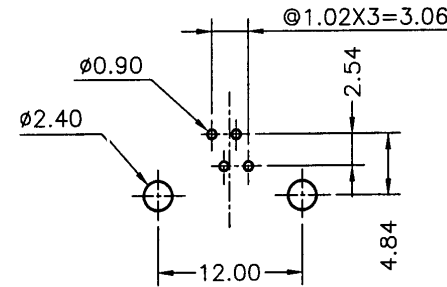

**PC Board Layout**

Series	Positions	Contacts	Type	Color	Plating	Options
CTJ	XX	XX	C1	XX	XX	XX
Modular Jack Single Port	4,6,8,10	2,4,6,8,10	Side entry, tab up, split peg	BK=Black GY=Gray	P1=15 u" P2=30 u" P3=50 u"	Blank=None WF=Without Flange KY=Keyed

**RoHS compliant**

Rev.	Description	Date	Approved	Drawing	Name	Date
A	PT	8/03/07	Grey	Approved	Howard	06/10/99
				Checked	Lizzy	06/10/99
				Drawn	Tina	06/10/99
		0.0 ± 0.35	0.00 ± 0.20	Angles ± 3°		
				UNIT: mm		

**Central Components Manufacturing**  
 440 Lincoln Blvd., Middlesex, New Jersey 08846  
 Phone 732 469-5720 888 288-5152 Fax 732 469-1919

Part No.: **CTJ-6-04-C1-XX-PX**

Description: Modular jack, 6P4C, type C1