

PCB LAYOUT/TOP VIEW

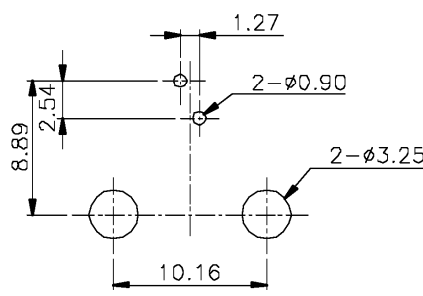

SPECIFICATIONS

- Contact material: Phosphor bronze
- Contact plating: Gold over Nickel
- Tin over Nickel in Solder Area
- Housing Material: Polyester UL94V-0, Black

Series	Positions	Contacts	Body Style	Color	Plating	Options
CTJ	X	XX	3019	BK	PX	XX
Modular jack, single port	6,8,10	02,04,06,08,10	3019 style	BK=Black	P1=15μ" gold P2=30μ" gold P3=50μ" gold	[blank]=None MS=Face shield KY=Keyed WF=No Flange

RoHS compliant

Rev.	Description	Date	Approved	Drawing	Name	Date
				Approved	Howard	08/10/99
				Checked	Lizzy	08/10/99
				Drawn	Tina	08/10/99
				0.0 ± 0.35	0.00 ± 0.20	Angles ± 3'
				UNIT: mm		

Central Components Manufacturing
 440 Lincoln Blvd., Middlesex, New Jersey 08846
 Phone 732 469-5720 888 288-5152 Fax 732 469-1919

Part No.: **CTJ-6-02-3019-BK-PX-WF**

Description: Side Entry PCB Jack

Grid lines labeled 1-9 horizontally and A-G vertically.