

(FOR 4POS
PLUG USE)

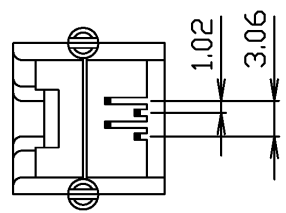

SPECIFICATIONS

Housing Material: PBT Polyester UL94V-0
 Contact Material: .45mm Diameter Phosphor Bronze Plated with Gold Plating

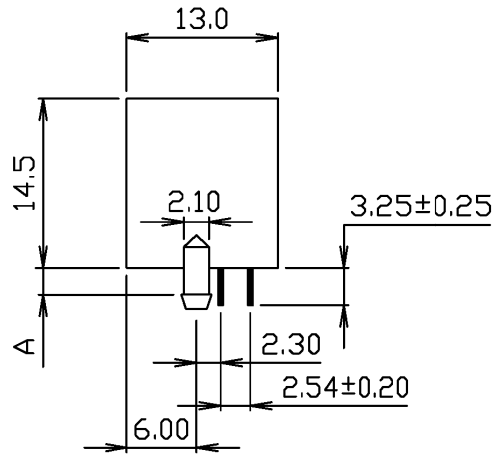
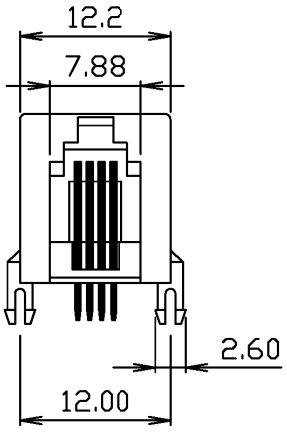
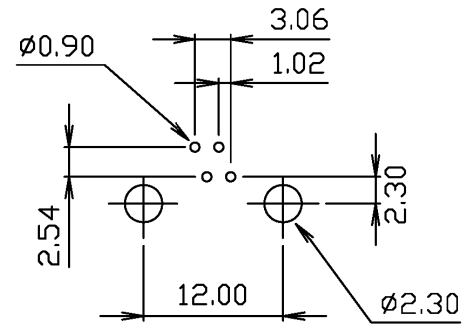

PC Board Layout

Series	Positions	Contacts	Type	Color	Plating	Options
CTJ	XX	XX	C	XX	XX	XX
Modular Jack Single Port	4,6,8,10	2,4,6,8,10	Side entry, tab up, split peg	BK=Black GY=Gray	P1=15 u" P2=30 u" P3=50 u"	Blank=None WF=Without Flange KY=Keyed

RoHS compliant

Rev.	Description	Date	Approved	Drawing	Name	Date
				Approved	Howard	06/10/99
				Checked	Lizzy	06/10/99
				Drawn	Tina	06/10/99
				0.0 ± 0.35	0.00 ± 0.20	Angles ± 3°
				UNIT: mm		

Central Components Manufacturing
 440 Lincoln Blvd., Middlesex, New Jersey 08846
 Phone 732 469-5720 888 288-5152 Fax 732 469-1919

Part No.: **CTJ-4-04-C-XX-XX-WF**

Description: Side entry, Low Profile, 4P4C Modular Jack