

**SPECIFICATIONS**

Current rating: 1 amp  
 Contact material: Phosphor bronze  
 Contact resistance: 20 milliohms max.  
 Insulator material: Polyester, UL94V-0  
 Insulator resistance: 1,000 megohms min  
 Withstanding: 300VAC for 1 min.  
 Operating temperature: -40°C to 105°C

Note: SMT 26-50 pin devices use LCP and 02-25 pin devices use PA6T

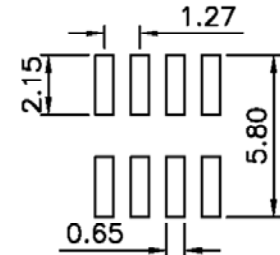
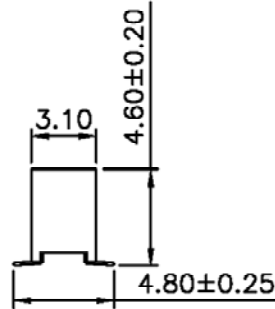
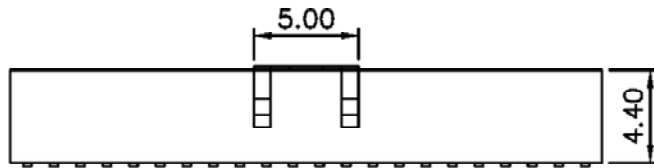

Recommended PCB Layout

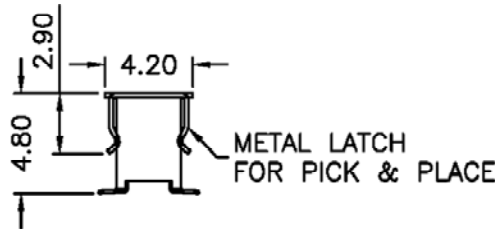
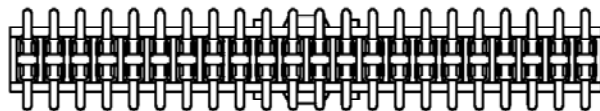

Series	Rows	Positions	Plating	Options
CRS	02	XX	XX	XX
Pin header 0.05" x 0.05" pitch	02=Dual row 02B=With flange	04-100	TN=Tin SG=Duplex GD=Gold	SM=Surface mount PPL=With cap

RoHS compliant

Rev.	Description	Date	Approved	Drawing	Name	Date
				Approved	Howard	08/10/99
				Checked	Lizzy	08/10/99
				Drawn	Tina	08/10/99
				0.0 ± 0.35	0.00 ± 0.20	Angles ± 3'
				UNIT: mm		

**Central Components Manufacturing**  
 440 Lincoln Blvd., Middlesex, New Jersey 08846  
 Phone 732 469-5720 888 288-5152 Fax 732 469-1919

Part No.: **CRS-02-XX-XX-SMPPL**

Description: 1.27mm female header, dual rows, SMT type