

**Recommended
P.C. Board SMD Layout**

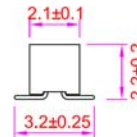
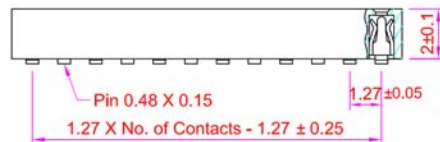
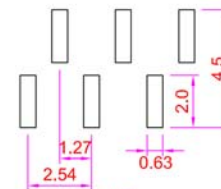
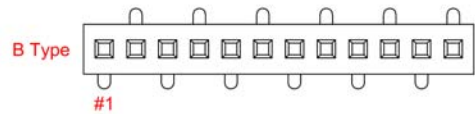
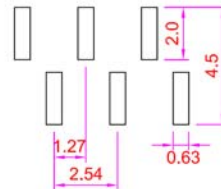
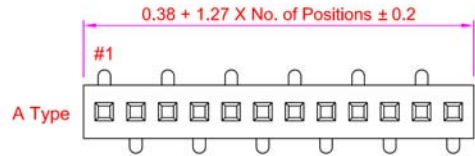

SPECIFICATIONS

Current Rating:	1 Amps
Contact Material:	Phosphor Bronze
Contact Plating:	Full gold, full tin, selective plating
Contact Resistance:	20m ohms max.
Insulator Material:	Polyester, UL94V-0 Standard: LCP
Insulator Resistance:	1000 Megohms min.
Withstanding:	AC 300V
Operating Temp:	-40C ~ +105C
Max. Processing Temp:	230C for 30-60 Seconds (260C for 10 seconds)

Series	Positions	Profile	Contacts	Spacing	Plating	Options
CRS	01	XX	XX	A	XX	XX
Receptacle strip, 0.05" x 0.05" pitch	01=Single Row 02=Dual Row	LPD=2.2mm others available	Single Row: 2-40	A=Standard	TN=Tin GDXX=Gold SGXX=Selective gold XX=Flash if blank; 10, 15, 30u"	SMX=Surface mount (see diagram)

RoHS compliant

Rev.	Description	Date	Approved	Drawing	Name	Date
				Approved	Howard	03/24/06
				Checked	Lizzy	03/24/06
				Drawn	Tina	03/24/06
				0.0 ± 0.35	0.00 ± 0.20	Angles ± 3'
				 UNIT: mm		

Central Components Manufacturing
 440 Lincoln Blvd., Middlesex, New Jersey 08846
 Phone 732 469-5720 888 288-5152 Fax 732 469-1919

Part No.: **CRS-01-XX-XX-A-XX-SMX**

Description: Female Header