

SPECIFICATIONS

Frequency Range: 0-26.5 HGz
 VSWR: 1.05 ± .02 (GHz) maximum at 0-18 GHz, <1.50 typical at 18-26.5 GHz
 Working Voltage: 170 Vrms maximum at sea level, 45 Vrms maximum at 70k feet
 Withstanding: 500 Vrms minimum at sea level
 Dispensing: Black Epoxy DEO-2713 : DEO-2713Ax2
 Procedure: Right in and Left out. Fill in fully and clean
 Harden Time: Normal Temp (25C) for 5-7 days or 80C at 1 hour
 (Inspection)
 Interface: 1.88mm ~ 1.98mm
 Epoxy Force: 2Kgf
 Male and Female Mating

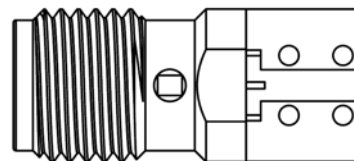
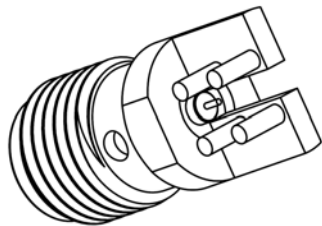

RoHS compliant

Item	Name	Material	Finish
1	Body	Brass	Gold 4u"
2	Center Pin	BeCu	Gold 20u"
3	Insulator	PTFE	

Rev.	Description	Date	Approved	Drawing	Name	Date
				Approved	Howard	05/20/15
				Checked	Lizzy	05/20/15
				Drawn	Tina	05/20/15
				0.0 ± 0.35	0.00 ± 0.20	Angles ± 3°
				UNIT: mm		

Central Components Manufacturing
 440 Lincoln Blvd., Middlesex, New Jersey 08846
 Phone 732 469-5720 888 288-5152 Fax 732 469-1919

Part No.: **CRF-SMA-EL-0761-BNTG-A**

Description: SMA Jack Receptacle PC Mount, Round Body