

RECOMMENDED
CABLE STRIPPING DIM^{ns}

CRIMPED FERRULE
Hex Crimp Size .128" (3.25mm)

SOLDER CONTACT PIN

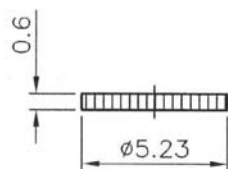
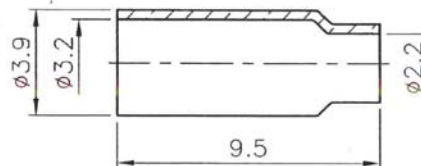

Item	Name	Material	Finish
1	Body	Brass Per QQ-B-626	Gold PL 3 Min over Nickel PL 70 min thick over Copper Strike
2	Insulator	Teflon MIL-P-19468	White
3	Contact Pin	Beryllium Copper Per QQ-C-530	Gold PL 30 Min over Nickel PL 70 min thick over Copper Strike
4	C Ring	Beryllium Copper per QQ-C-530	None
5	Gasket	Silicone	Red
6	Shell	Brass Per QQ-B-626	Gold PL 3 over Nickel PL 70 min thick over Copper Strike
7	Ferrule	Brass JIS H 3250, C 2700	Gold PL 3 over Nickel PL 70 min thick over Copper Strike
8	Cover	Brass PER QQ-B-613	Gold PL 3 Min over Nickel PL 70 min thick over Copper Strike

RoHS compliant

Rev.	Description	Date	Approved	Drawing	Name	Date
				Approved	Howard	02/19/08
				Checked	Lizzy	02/19/08
				Drawn	Tina	02/19/08
				0.0 ± 0.35	0.00 ± 0.20	Angles ± 3'
						UNIT: mm

Central Components Manufacturing
440 Lincoln Blvd., Middlesex, New Jersey 08846
Phone 732 469-5720 888 288-5152 Fax 732 469-1919

Part No.: **CRF-RP-SMA-2811NR-528BD000B**

Description: SMA R/P R/A Crimp Plug