

SPECIFICATIONS

Current Rating: 20VDC 7.5A Max
 Withstanding: 250V RMS / minute
 Insulation Resistance: 50M Ohm Min @ 250VDC (before testing)
 5MOhm Max @20mA, 1KHZ (after testing)
 Contact Resistance: 30m Ohm Max @ 20mA, 1KHZ (before testing)
 60m Ohm Max @20mA, 1KHZ (after testing)
 Insertion Force: 6.0KG Max
 Withdrawal Force: 0.5-6.0KG

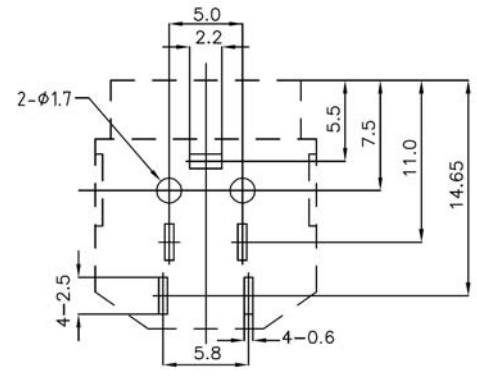

HOLE LAYOUT
BOTTOM VIEW

Item	Name	Material	Finish
1	Body	PBT	UL94V-0
2	Cover	PBT	UL94V-0
3	Earth Terminal	BSR-H 0.4t	Pb10%, Sn90%
4	Contact Terminal	BSR-H 0.3t	Pb10%, Sn90%

Series	Type	Contacts	Shield
CPMDJ	003	XX	X
Mini Din Power Jack	Type 003	4 Power 0 Data	Blank=None B=4 Sides

RoHS compliant

Rev.	Description	Date	Approved	Drawing	Name	Date
				Approved	Howard	10/27/00
				Checked	Lizzy	10/27/00
				Drawn	Tina	10/27/00
				0.0 ± 0.35	0.00 ± 0.20	Angles ± 3'
				UNIT: mm		

Central Components Manufacturing
 440 Lincoln Blvd., Middlesex, New Jersey 08846
 Phone 732 469-5720 888 288-5152 Fax 732 469-1919

Part No.: **CPMDJ-003-40**

Description: Mini DIN Power Jack

