

SPECIFICATIONS

Current rating: 1 amp
 Contact material: Brass
 Contact plating: Gold, tin or duplex
 Insulator material: Polyester, UL94V-0
 Insulator resistance: 5,000 megohms min.
 Withstanding: 500VAC for 1 min.
 Operating temperature: -40°C to +105°C

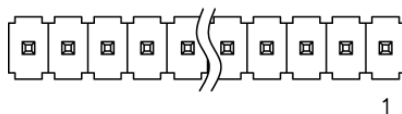

Recommended PC Board Hole Layout

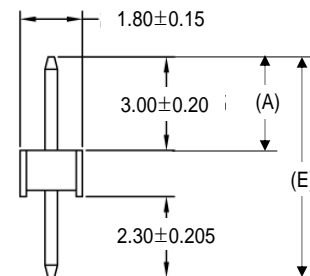
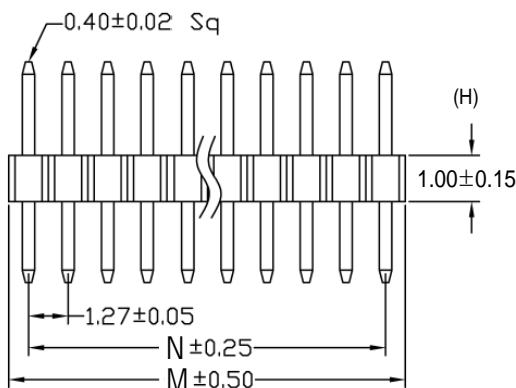
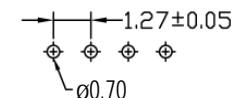

N=1.27 x (no pos. -1)
 M=1.27 x (no. pos)

Series	Height H (mm)	No. of Rows	Type	No. of Pins	Pin Length (in)	Plating	Options	Package
CPH	X	X	XX	XX	SD, CS(A/E) or CS(A/C/E)	XX	XX	XX
Pin header 40mm square pins	[blank]=1.50, B=1.00, C=1.70*, D=2.00, E=2.54* *Dual row only	1=Single row 2=Dual rows	[blank]=Straight RA=Right angle RRA=Reverse R/A RASM=R/A SMT SMX=Surface mount	1-40 (single row) 2-80 (double row)	SD=Standard .12" (3.0mm) mating, .09" (2.3mm) tail CS=Customer specified pin length	TN=Tin SGXX=Duplex GDXX=Gold XX=Flash if blank, 03, 05, 10, 15, 30µ"	Blank=None HT=High Temp	Blank=Bulk PPL=Pick Cap PPT=Pick Tape TB=Tube TR=Tape & Reel

RoHS compliant

Rev.	Description	Date	Approved	Drawing	Name	Date
A	Dimensions	06/02/05	Tom	Approved	Howard	08/10/99
				Checked	Lizzy	08/10/99
				Drawn	Tina	08/10/99
				0.0 ± 0.35	0.00 ± 0.20	Angles ± 3'
				UNIT: mm		

Central Components Manufacturing
 440 Lincoln Blvd., Middlesex, New Jersey 08846
 Phone 732 469-5720 888 288-5152 Fax 732 469-1919

Part No.: **CPH-B-1-XX-SD-XX**

Description: Pin header, 1.27mm (0.050") pitch, 1 mm insulator