

SPECIFICATIONS

Current rating: 1 amp
 Contact material: Brass
 Contact plating: Gold flash over nickel
 Contact resistance: 20 milliohms max.
 Insulation material: Nylon 6T
 Insulation resistance: 1,000 megohms min.
 Withstanding: 500VAC for 1 min.
 Operating temperature: -40°C to +85°C

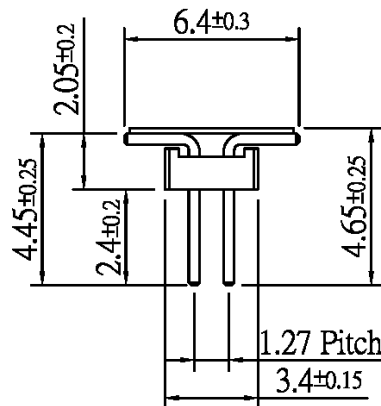
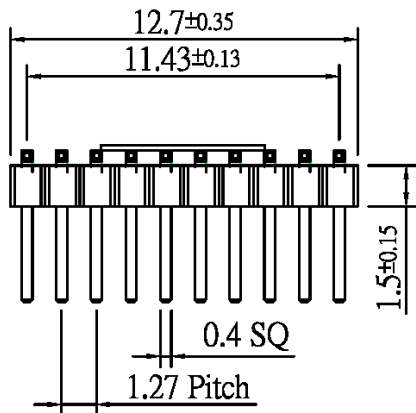
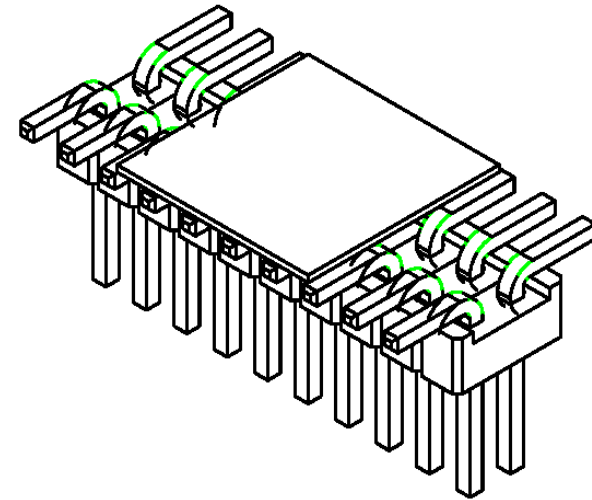

Series	Height H (mm)	No. of Rows	Type	No. of Pins	Pin Length	Plating	Options
CPH	X	2	SM	XX	CS2.4	XX	XX
Pin header, male, unshrouded, 1.27mm pitch	[blank]=1.50, B=1.00, C=1.70*, D=2.00, E=2.54* *Dual row only	2= Dual rows 1= Single row	[blank]=Straight SM=Surface mount RA=Right angle	1-40 (single row) 2-80 (double row)	CS2.4=0.9" (2.4mm) contact length	SGXX=Duplex GDXX=Gold XX=Flash if blank, 03, 05, 10, 15, 30µ"	TN=Tin [blank]=None CP=Centering pin PPL=Pick cap TR=Tape & reel TB=Tube

RoHS compliant

Rev.	Description	Date	Approved	Drawing	Name	Date
				Approved	Howard	06/27/07
				Checked	Lizzy	06/27/07
				Drawn	Tina	06/27/07
				0.0 ± 0.35	0.00 ± 0.20	Angles ± 3'
				UNIT: mm		

Central Components Manufacturing
 440 Lincoln Blvd., Middlesex, New Jersey 08846
 Phone 732 469-5720 888 288-5152 Fax 732 469-1919

Part No.: **CPH-2-SM-20-CS2.4-GD-TR-PPL**

Description: Pin header, 1.27mm pitch, dual row, SMT type