

SPECIFICATIONS

Current rating: 12A (CUL), 10A (VDE)
 Voltage Rating: AC 150V (CUL), AC300V (VDE)
 Solder Pin: Brass, Tin Plated
 Insulation Material: Polyamide 66 UL94V-0, Green
 Insulation Resistance: 2000MΩ min
 Withstanding: AC 2000V min
 Operating Temp: -40°C to +105°C

Dimensions (inch)			
Poles	A	Poles	A
2	7.6 (0.299)	15	53.1 (2.091)
3	11.1 (0.437)	16	56.6 (2.228)
4	14.6 (0.575)	17	60.1 (2.366)
5	18.1 (0.713)	18	63.6 (2.504)
6	21.6 (0.850)	19	67.1 (2.642)
7	25.1 (0.988)	20	70.6 (2.780)
8	28.6 (1.126)	21	74.1 (2.917)
9	32.1 (1.264)	22	77.6 (3.055)
10	35.6 (1.402)	23	81.1 (3.193)
11	39.1 (1.539)	24	84.6 (3.331)
12	42.6 (1.677)		
13	46.1 (1.815)		
14	49.6 (1.953)		

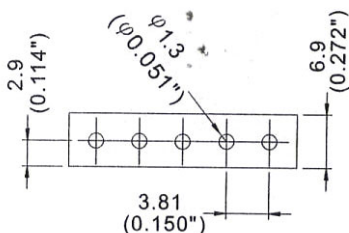
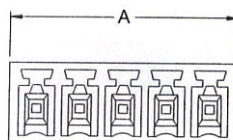
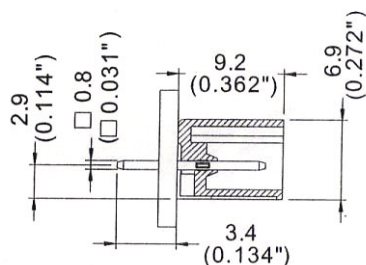

PCB Layout

Series	Style	Pitch	Positions	Color
CMTB	ME040	XXX	XX	GN
Terminal block	Vertical closed end plug-able	350=3.50mm 381=3.81mm 500=5mm 508=5.08mm 762=7.62mm	02-24	GN=Green

RoHS compliant

Rev.	Description	Date	Approved	Drawing	Name	Date
				Approved	Howard	10/17/05
				Checked	Lizzy	10/17/05
				Drawn	Tina	10/17/05
				0.0 ± 0.35	0.00 ± 0.20	Angles ± 3'
				UNIT: mm		

Central Components Manufacturing
 440 Lincoln Blvd., Middlesex, New Jersey 08846
 Phone 732 469-5720 888 288-5152 Fax 732 469-1919

Part No.: **CMTB-ME040-350-XX-GN**

Description: Terminal block, vertical, closed end, plug-able