

**SPECIFICATIONS**  
 2-24 Positions  
 Current Rating: 15A  
 Voltage Rating: 300V  
 A Length: 5.00xP(P≥2)  
 Housing Material: PA 66 UL94V-0  
 Pin Dimensions: Brass, Tin Plated  
 PCB Hole Diameter: 1.2mm  
 Withstanding: 10A  
 Operating Temp: -40°C to +105°C

PCB Layout

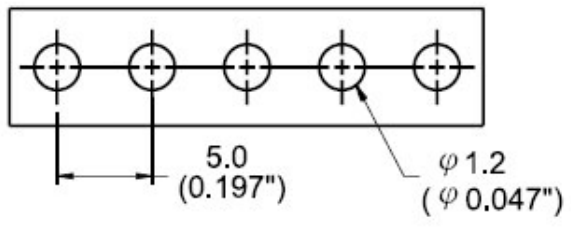

RoHS compliant

Rev.	Description	Date	Approved	Drawing	Name	Date
				Approved	Howard	12/11/09
				Checked	Lizzy	12/11/09
				Drawn	Tina	12/11/09
				0.0 ± 0.35	0.00 ± 0.20	Angles ± 3'
						UNIT: mm

**Central Components Manufacturing**  
 440 Lincoln Blvd., Middlesex, New Jersey 08846  
 Phone 732 469-5720 888 288-5152 Fax 732 469-1919

Part No.: **CMTB-MD122-500-XX-BK**

Description: Header 5.00mm Pitch