

1 2 3 4 5 6 7 8 9

A

B

C

D

E

F

G

A

B

C

D

E

F

G

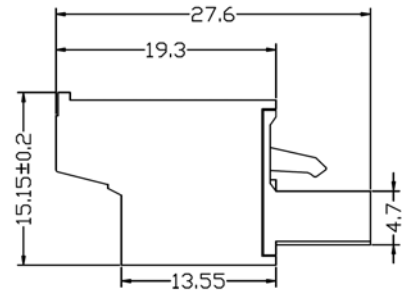
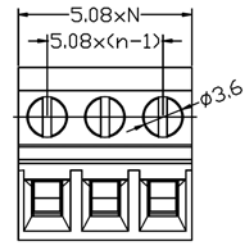
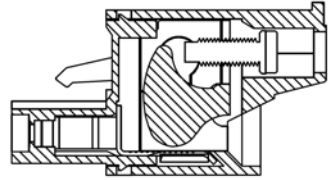

**SPECIFICATIONS**

- Voltage Rating: 300V
- Current Rating: 15A
- Contact Resistance: 20mΩ
- Insulation Resistance: 5000MΩ/1000V
- Withstanding: AC2000V/1Min
- Wire Range: 28-12AWG 2.5mm<sup>2</sup>
- Screw Material: M2.5 Steel Zinc Plated
- Contact Material: Phosphor Bronze
- Housing Material: PA66, UL94V-0
- Torque: 0.4Nm (3.6lb. In)
- Strip Length: 7-8mm
- Temperature Range: -40C ~ +105C

Series	Type	Pitch	Positions	Color
CMTB	K203	XXX	XX	XX
Terminal Block	K203=Top Entry, Top Screw K203F= With Mounting Flange	508=5.08mm	02-24	GN=Green

RoHS compliant

Rev.	Description	Date	Approved	Drawing	Name	Date
				Approved	Howard	12/03/10
				Checked	Lizzy	12/03/10
				Drawn	Tina	12/03/10
				0.0 ± 0.35	0.00 ± 0.20	Angles ± 3°
				UNIT: mm		

**Central Components Manufacturing**  
 440 Lincoln Blvd., Middlesex, New Jersey 08846  
 Phone 732 469-5720 888 288-5152 Fax 732 469-1919

Part No.: **CMTB-K203-508-XX-GN**

Description: Terminal Block

1 2 3 4 5 6 7 8 9