

RECOMMENDED PCB LAYOUT

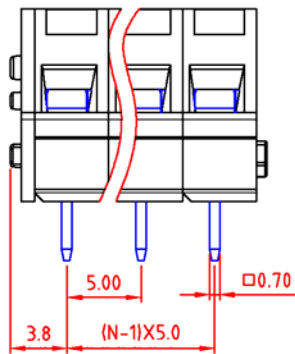

N=Number of contacts

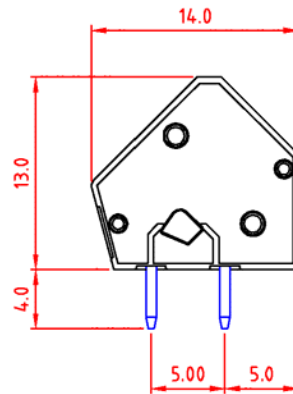

**SPECIFICATIONS**

Current Rating: 15A  
 Voltage Rating: 300V  
 Contact Material: Brass  
 Solder Tail Surface: Tin Plated  
 Wire Guard: Stainless Steel  
 Insulator Material: Thermoplastic UL94V-0  
 Withstanding: 1.6KV  
 Operating Temp: -30°C to +105°C  
 Soldering Temp: 245°C ± 10°C/5 Sec

**WIRE RANGE**

Solid Wire (AWG): 12-28  
 Stranded Wire (AWG): 12-28  
 Wire Strip Length: 6-7mm

Series	Type	Pitch	Positions	Color
CMTB	HG	XXX	XX	XX
Terminal Block	45° Entry	500=5.00mm 508=5.08mm 750=7.50mm 762=7.62mm 1000=10.00mm 1016=10.16mm	02-24	GN=Green BK=Black BL=Blue GY=Gray

RoHS compliant

Rev.	Description	Date	Approved	Drawing	Name	Date
				Approved	Howard	04/16/08
				Checked	Lizzy	04/16/08
				Drawn	Tina	04/16/08
				0.0 ± 0.35	0.00 ± 0.20	Angles ± 3'
					UNIT: mm	

**Central Components Manufacturing**  
 440 Lincoln Blvd., Middlesex, New Jersey 08846  
 Phone 732 469-5720 888 288-5152 Fax 732 469-1919

Part No.: **CMTB-HG-500-XX-XX**

Description: HG 5.0mm Series