

N=Number of contacts

SPECIFICATIONS
 Voltage Rating: 250V Rated
 Current Rating: 16A Contact
 Insulation Resistance: 20mΩ
 Contact Resistance: 5000mΩ / 1000V
 Withstanding: AC1500V/1min
 Range: 22-14AWG 2.5mm²
 Torque: 0.4Nm (3.6lb in) Strip
 Length: 5-6mm
 Max Soldering: +250°C 5Sec.
 Temp Range: -30°C ~ +120°C

P.C.B. LAYOUT

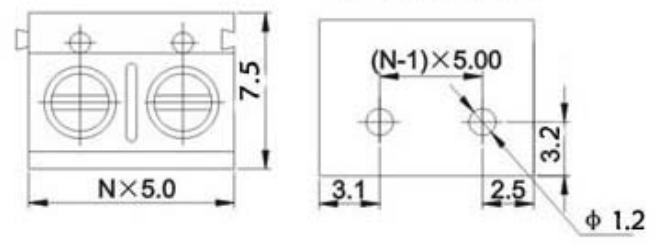

Pitch:5mm,10mm

Series	Type	Pitch	Positions	Plating	Color
CMTB	FM412V	XXX	XX	XX	XX
Terminal block	Side entry top screw modular	500=5.00mm 508=5.08mm (.200") 1000=10mm 1016=10.16mm	02,03	TN=Tin GD=Gold	GN=Green BK=Black GY=Gray BL=Blue

RoHS compliant

Rev.	Description	Date	Approved	Drawing	Name	Date
				Approved	Howard	06/04/10
				Checked	Lizzy	06/04/10
				Drawn	Tina	06/04/10
				0.0 ± 0.35	0.00 ± 0.20	Angles ± 3'
				UNIT: mm		

Central Components Manufacturing
 440 Lincoln Blvd., Middlesex, New Jersey 08846
 Phone 732 469-5720 888 288-5152 Fax 732 469-1919

Part No.: **CMTB-FM412-XXX-XX-XX**
 Description: Terminal block, PCB mount, side entry top screw wire guard.