

SPECIFICATIONS

Voltage Rating: 300V/300V
 Current Rating: 10A/10.5A
 Withstanding: 1.6 KV/2.5KV
 Contact Pin: Tin Plating
 Housing: Thermoplastic UL94V-0
 Operating Temp: -40C to +115C
 Soldering Temp: 250°C ± 10°C / 5 Sec

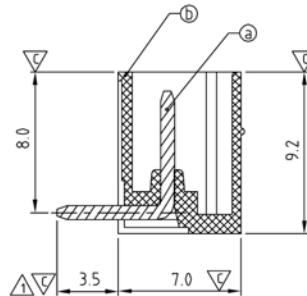
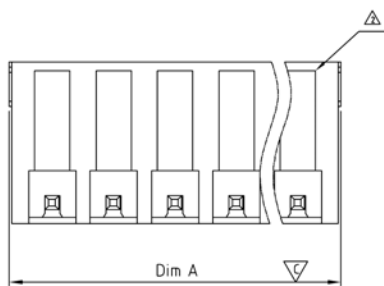

DIMENSION

| | |
|---|----------------|
| A | (N-1)×3.5+4.90 |
| B | (N-1)×3.5 |

N= NUMBER OF CONCATS

| Poles | Tolerance |
|---------|-----------|
| 2P-6P | ±0.15 |
| 7P-12P | ±0.20 |
| 13P-18P | ±0.25 |
| 19P-24P | ±0.30 |

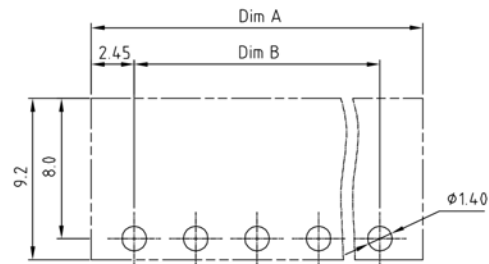

RECOMMENDED PCB LAYOUT

| Series | Type | Pitch | Positions | Plating | Color |
|----------------|-------------|------------|-----------|---------|--|
| CMTB | AK121 | 350 | XX | XX | XX |
| Terminal block | See Drawing | 350=3.50mm | 2-24 | TN=Tin | BK=Black RD=Red OR=Orange YL=Yellow GN=Green BL=Blue GY=Grey |

RoHS compliant

| Rev. | Description | Date | Approved | Drawing | Name | Date |
|------|-------------|------|----------|------------|-------------|-------------|
| | | | | Approved | Howard | 05/14/12 |
| | | | | Checked | Lizzy | 05/14/12 |
| | | | | Drawn | Tina | 05/14/12 |
| | | | | 0.0 ± 0.35 | 0.00 ± 0.20 | Angles ± 3' |
| | | | | UNIT: mm | | |

Central Components Manufacturing
 440 Lincoln Blvd., Middlesex, New Jersey 08846
 Phone 732 469-5720 888 288-5152 Fax 732 469-1919

Part No.: **CMTB-AK121-350-XX-TN-XX**

Description: 3.5mm 90° Triangle Key Lock