

1 2 3 4 5 6 7 8 9

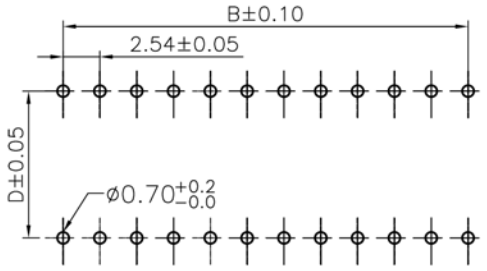

SPECIFICATIONS
 Current Rating: 1.0A AC/DC
 Voltage Rating: 100V AC/DC
 Contact Resistance: 15m ohm. Max.
 Insulator Resistance: 5000M ohm min.
 Withstanding: 1000V AC for one minute
 Insulator: PBT UL94V-0, Black
 Contact: Beryllium Copper, Gold Plated
 Sleeve: Copper Alloy, Tin Plated
 Processing Temp: 235°C for 5 Sec
 Operating Temp: -40C to +105C

PCB Layout

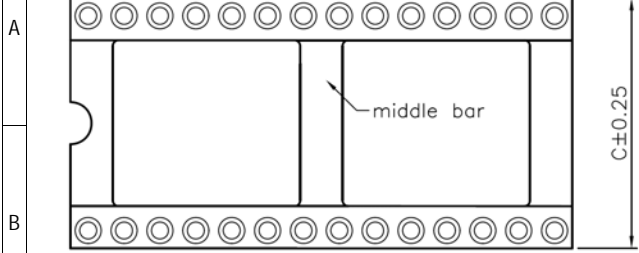
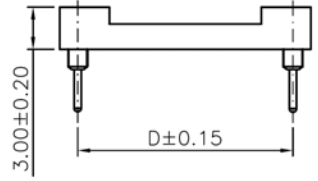
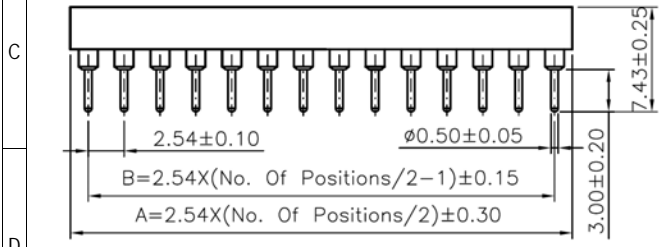

W/O middle bar (6~16P)
 With middle bar (18-48P)

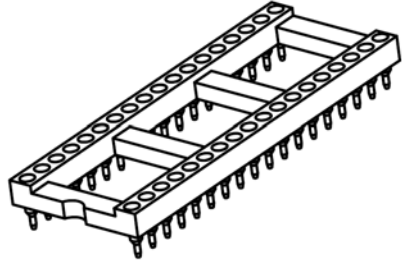

.3" Row Space .6" Row Space

Dimensions										
Circuits	A	B	C	D		Circuits	A	B	C	D
06	7.62	5.08	10.16	7.62		24	30.48	27.94	17.78	15.24
08	10.16	7.62	10.16	7.62		28	35.56	33.02	17.78	15.24
14	17.78	15.24	10.16	7.62		32	40.64	38.10	17.78	15.24
16	20.32	17.78	10.16	7.62		40	50.80	48.26	17.78	15.24
18	22.86	20.32	10.16	7.62		42	53.34	50.80	17.78	15.24
20	25.40	22.86	10.16	7.62		48	60.96	58.42	17.78	15.24
24	30.48	27.94	10.16	7.62						
28	35.56	33.02	10.16	7.62						

RoHS compliant

Series	Positions	Plating	Frame
CMCX	XX	XX	XXX
Machine Contact Socket	3: 06, 08, 10, 14, 16, 18, 20, 22, 24, 28	TN=Tin SGXX=Selective	Blank=Std open with bars
X=3,4,6" Row Space	4: 20, 22, 24, 28, 32	GDXX=Gold	OPN=Open
	6: 24, 28, 32, 26, 40, 42, 48, 50, 52	XX=Flash if blank, 10,30u"	CLD=Closed

Rev.	Description	Date	Approved	Drawing	Name	Date
				Approved	Howard	06/01/07
				Checked	Lizzy	06/01/07
				Drawn	Tina	06/01/07
				0.0 ± 0.35	0.00 ± 0.20	Angles ± 3'

Central Components Manufacturing
 440 Lincoln Blvd., Middlesex, New Jersey 08846
 Phone 732 469-5720 888 288-5152 Fax 732 469-1919

Part No.: **CMCX-XX-XX-XXX**

Description: SD-IC Socket

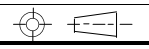

UNIT: mm

1 2 3 4 5 6 7 8 9