

SPECIFICATIONS

Current rating: 2 amps
 Contact material: Phosphor bronze, gold plated
 Contact resistance: 30 milliohms max. at DC 100mA
 Housing: High temp. housing, UL94V-0
 Insulation resistance: 1,000 megohms min. at 500VDC
 Withstanding: 1,000VAC for 1 min.
 Operating temperature: -65°C to +125°C

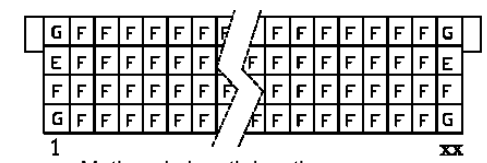

Mating pin length locations
 E=4.65mm
 F=5.65mm
 G=6.65mm

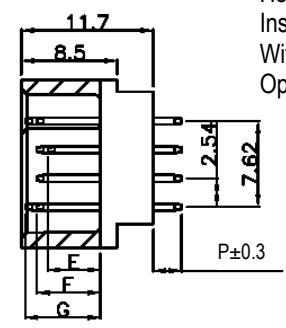
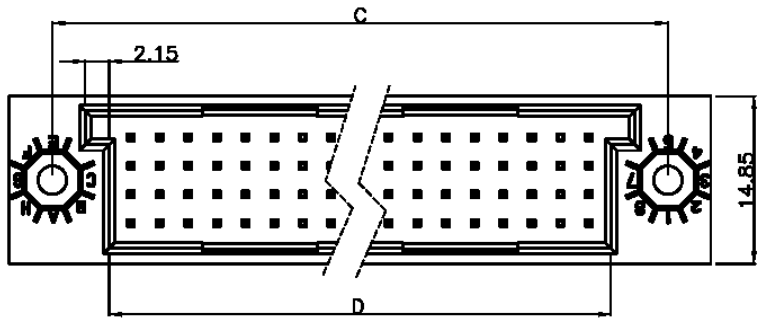
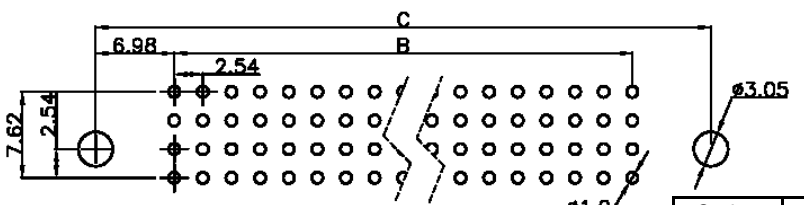

P.C. Board Layout
 (Tolerance: ±0.05)

Dimensions	
A	2.54 x No. of Positions/4 + 19.05
B	2.54 x No. of Positions/4 + 2.54
C	2.54 x No. of Positions/4 + 11.43
D	2.54 x No. of Positions/4 + 1.32

Series	Gender	Mounting	Contacts	Pin Length (P)	Pitch	Loaded Rows	Plating
CED	X	X	XXX	XX	B1	8	SGX
DIN41612	1=Male	A=Straight	100, 120, 128, 140, 160, 180, 200, 220, 240	A1=4.00mm A2=2.50mm	B1=2.54mm	8=A, B, C & D	Selective gold SG1=30µ" (Level 1) SG2=15µ" (Level 2) SG3=10µ" (Basic)

RoHS compliant

Rev.	Description	Date	Approved	Drawing	Name	Date
				Approved	Howard	08/10/99
				Checked	Lizzy	08/10/99
				Drawn	Tina	08/10/99
				0.0 ± 0.35	0.00 ± 0.20	Angles ± 3'
				UNIT: mm		

Central Components Manufacturing
 440 Lincoln Blvd., Middlesex, New Jersey 08846
 Phone 732 469-5720 888 288-5152 Fax 732 469-1919

Part No.: **CED-1-A-XXX-XX-B1-8-SGX**

Description: DIN 41612, 240 pin, 4 row, male