

CDP Series

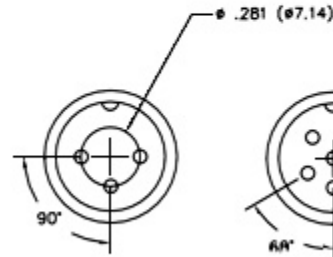

CDP-03

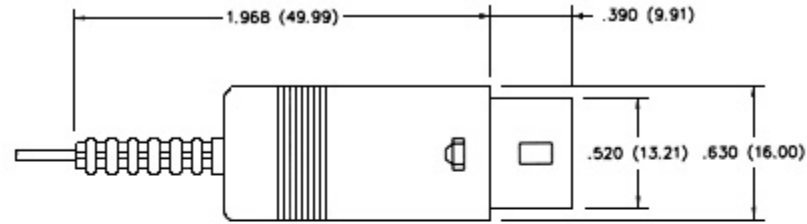

CDP-04



CDP-05



CDP-07



CDP-08

SPECIFICATIONS

Operating voltage:	100 VAC max.
Current rating:	2 amps max.
Contact material:	Phosphor bronze
Contact plating:	Silver over nickel
Contact resistance:	10 milliohms max.
Insulation resistance:	500 megohms min.
Withstanding:	250 VAC min. RMS
Shield material:	Steel, nickel plated
Inner shell material:	Nickel plated steel
Outer shell material:	PVC (polyvinyl chloride)
Insulator material:	PBT, glass reinforced, UL94V-0

Series	No. of Contacts	Special Options
CDP	XX	XX
Circular DIN plug	03, 04, 05, 06, 07, 08	GD=Gold contact plating BL=Barrel only

RoHS compliant

Rev.	Description	Date	Approved	Drawing	Name	Date
				Approved	Howard	08/10/99
				Checked	Lizzy	08/10/99
				Drawn	Tina	08/10/99
				0.0 ± 0.35	0.00 ± 0.20	Angles ± 3'
				UNIT: mm		



Central Components Manufacturing

440 Lincoln Blvd., Middlesex, New Jersey 08846
Phone 732 469-5720 888 288-5152 Fax 732 469-1919

Part No.: **CDP-XX-XX**

Description: Circular DIN plug