

SPECIFICATIONS

Current rating: 1 amp
 Contact material: Phosphor bronze
 Contact resistance: 30 milliohms max.
 Insulator material: PPS + 40% glass fiber, UL94V-0
 Insulator resistance: 1000 megohms min. at 500 VDC
 Withstanding: 500V/1 min.
 Operating temp: -55°C to +105°C

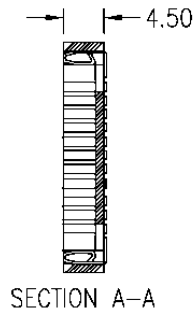
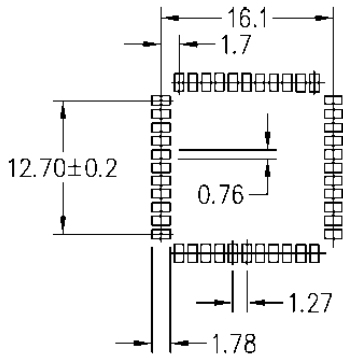

Recommended PC Board Layout

Series	Positions	Plating	Options
CCSM	XX	XX	XX
Low profile surface mount PLCC socket	20, 28, 32, 44, 52, 68, 84	TN=Tin GD=Gold	[blank]=None HT=High temp. NY=Nylon PP=Polarization peg

RoHS compliant

Rev.	Description	Date	Approved	Drawing	Name	Date
				Approved	Howard	08/10/99
				Checked	Lizzy	08/10/99
				Drawn	Tina	08/10/99
				0.0 ± 0.35	0.00 ± 0.20	Angles ± 3'
				UNIT: mm		

Central Components Manufacturing
 440 Lincoln Blvd., Middlesex, New Jersey 08846
 Phone 732 469-5720 888 288-5152 Fax 732 469-1919

Part No.: **CCSM-44-XX-XX**

Description: Low profile 44 position surface mount PLCC socket