

A-A SECTION

SPECIFICATIONS

- Current rating: 1 amp DC (signal) max.
5 amps DC (power) max.
- Power contact: Brass,
- Contact plating: Tin 120 μ min.
- Insulator material: PBT+glass fiber, UL94V-0, black
- Board lock: Phosphor bronze, tin plated
- Solder tail: Brass
- Solder tail finish: Tin 100 μ over nickel 50 μ
- Contact resistance: 20 milliohms max. (signal and power)
- Insulation resistance: 1000 megohms min.
- Withstanding: 500VAC (signal)
1000VAC (power) for 1 min.
- Temperature range: -45°C to +105°C

RETENTION FORCE

- Signal pin (#19st) 6.5 Kgf min.
- Signal pin (others): 0.7 Kgf min.
- Power pin: 2.5 Kgf min.

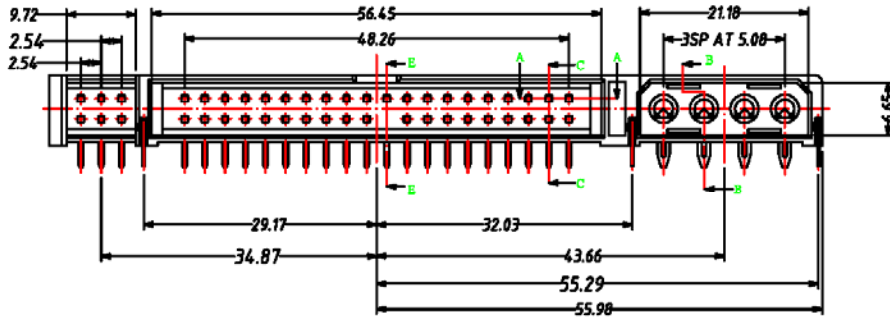
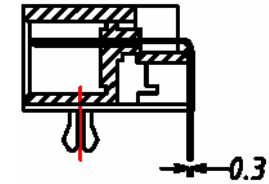

0.1 M-N Me

P.C.B LAYOUT

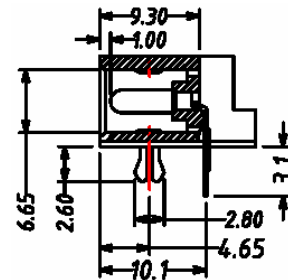
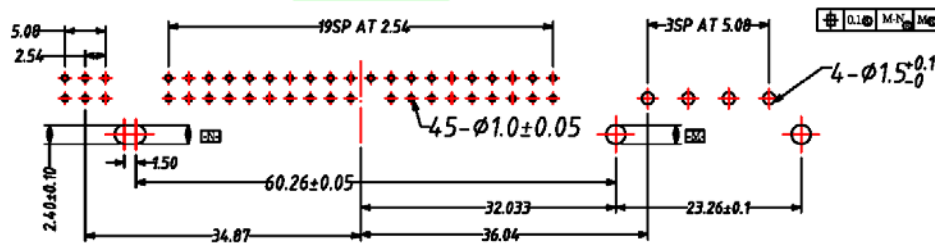

B-B SECTION

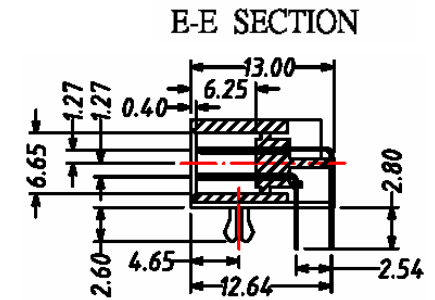

C-C SECTION

RoHS compliant

Rev.	Description	Date	Approved	Drawing	Name	Date
				Approved	Howard	08/10/99
				Checked	Lizzy	08/10/99
				Drawn	Tina	08/10/99
				0.0 ± 0.35	0.00 ± 0.20	Angles ± 3'
				UNIT: mm		

Central Components Manufacturing
 440 Lincoln Blvd., Middlesex, New Jersey 08846
 Phone 732 469-5720 888 288-5152 Fax 732 469-1919

Part No.: **CCHDC-01-C**

Description: E-type board lock