

$(0.40 + 0.80 * \text{No. of Positions}) \pm 0.10$

$(1.90 + 0.80 * \text{No. of Positions}) \pm 0.25$

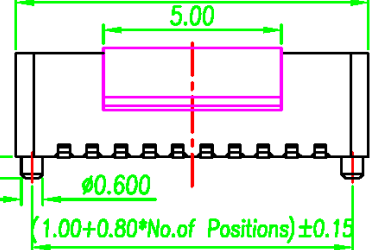

SPECIFICATIONS

Current rating: 0.5 amps
 Contact material: Phosphor bronze
 Contact plating: Selective gold, gold flash, tin
 Contact resistance: 20 milliohms max.
 Insulation material: Nylon 9T polyester, UL 94V-0
 Insulation resistance: 1000 megohms min.
 Withstanding: 300 VAC 1 min.
 Operating temp.: -40°C to +105°C

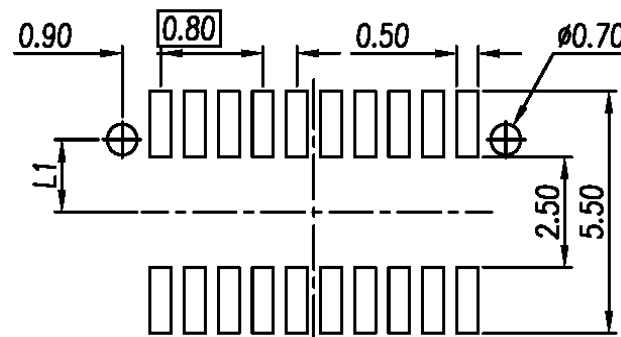
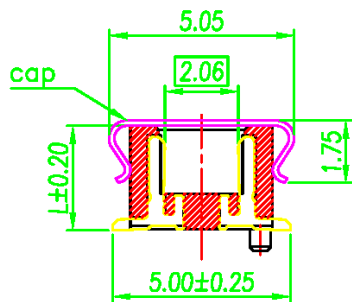

RECOMMENDED P.C. BOARD LAYOUT

Stacked Profile Dim. (mm)			
	Height	L	L1
1	4.00	2.90	1.650
1	4.50	2.90	1.650
1	5.00	2.90	1.650
2	5.50	3.40	1.650
2	6.00	3.40	1.650
2	6.50	3.40	1.650
3	7.00	3.90	1.650
4	7.00	3.90	1.250

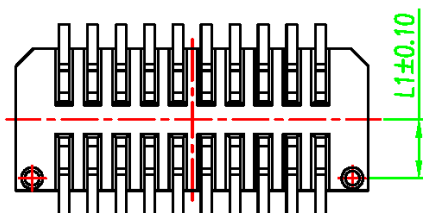

Series	Type	Profile	Contacts	Plating	Mounting	Package
CBB	SBC24	X	XX	XX	SM	XX
Board to board connector	Socket	See chart	08 to 50	GD=Gold flash GD15=15µ" gold SG=Selective gold SG15=15µ" SG TN=Tin	SM=Surface mount	PPL=Pick & place cap TR=Reel TPR=Reel & cap

RoHS compliant

Rev.	Description	Date	Approved	Drawing	Name	Date
				Approved	Howard	04/23/08
				Checked	Lizzy	04/23/08
				Drawn	Tina	04/23/08
				0.0 ± 0.35	0.00 ± 0.20	Angles ± 3'

Central Components Manufacturing
 440 Lincoln Blvd., Middlesex, New Jersey 08846
 Phone 732 469-5720 888 288-5152 Fax 732 469-1919

Part No.: **CBB-SBC24-X-XX-XX-SM-XX**

Description: 0.80mm female board-to-board SMD connector

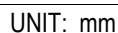
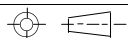

UNIT: mm