

SPECIFICATIONS

Insulation Material: Nylon 46 UL94V-0
 Contact Material: Copper Alloy, t=0.30mm
 Contact Finish: Gold Over Nickel

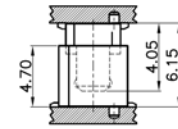

Mating Condition (REF.)

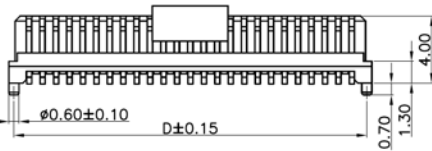

PIN	DIM.(mm)				PIN	DIM.(mm)			
	A	B	C	D		A	B	C	D
10	3.20	4.85	5.60	5.00	34	12.80	14.45	15.20	14.60
12	4.00	5.65	6.40	5.80	36	13.60	15.25	16.00	15.40
14	4.80	6.45	7.20	6.60	38	14.40	16.05	16.80	16.20
16	5.60	7.25	8.00	7.40	40	15.20	16.85	17.60	17.00
18	6.40	8.05	8.80	8.20	50	19.20	20.85	21.60	21.00
20	7.20	8.85	9.60	9.00	60	23.20	24.85	25.60	25.00
22	8.00	9.65	10.40	9.80	68	26.40	28.05	28.80	28.20
24	8.80	10.45	11.20	10.60	70	27.20	28.85	29.60	29.00
26	9.60	11.25	12.00	11.40	80	31.20	32.85	33.60	33.00
28	10.40	12.05	12.80	12.20	90	35.20	36.85	37.60	37.00
30	11.20	12.85	13.60	13.00	100	39.20	40.85	41.60	41.00
32	12.00	13.65	14.40	13.80					

Series	Type	Gender	Positions	Height	Plating	Packaging
CBB	4821	X	XXX	C	XX	XX
Board to Board Connector	0.8mm Pitch SMT	M=Male F=Female	See Chart	C=4.00	GDXX=Gold XX: Flash if blank, 3,5,10,15u"	TR=Tape & Reel TB=Tube TC=Tube w/ Cap

RoHS compliant

Rev.	Description	Date	Approved	Drawing	Name	Date
				Approved	Howard	03/23/10
				Checked	Lizzy	03/23/10
				Drawn	Tina	03/23/10
				0.0 ± 0.35	0.00 ± 0.20	Angles ± 3'
				UNIT: mm		

Central Components Manufacturing
 440 Lincoln Blvd., Middlesex, New Jersey 08846
 Phone 732 469-5720 888 288-5152 Fax 732 469-1919

Part No.: **CBB-4821-F-XXX-C-GDXX-XX**
 Description: 0.8mm Pitch B to B Connector, Dual Row, SMT Type 4821