

SPECIFICATIONS
 Current Rating: 2 Amps
 Insulator Resistance: 1000 Megohms min.
 Contact Resistance: 20m ohms max.
 Withstanding: AC 500V
 Contact Material: Phosphor Bronze
 Contact Plating: Gold Flash (std)
 Insulator Material: Polyester, UL94V-0 Nylon 6T
 Operating Temp: -40C ~ +105C

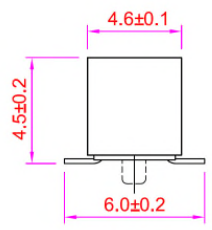
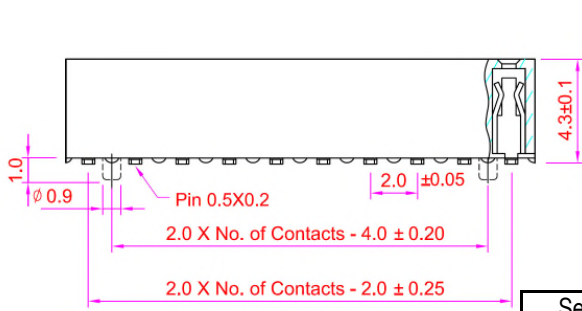

Series	Rows	Profile	Contacts	Plating	Options	Package
BRS	0X	XXW	XX	XX	XX	XXX
2mm Receptacle strip	01=Single 02=Dual	XX: [Blank]=4.3mm W=4.6mm width	Single Row 1-40 Dual Row 2-80	TN=Tin SGXX=Selective Gold GDXX=Gold XX=flash if blank, 10, 15, 30μ"	[blank]=None SM=Surface Mount CP=Centering Post	TRX=Tape & Reel TBX=Tube X:F=Film M=Metal Cap P=Plastic Cap N=No Cap

RoHS compliant

Rev.	Description	Date	Approved	Drawing	Name	Date
				Approved	Howard	04/23/07
				Checked	Lizzy	04/23/07
				Drawn	Tina	04/23/07
				0.0 ± 0.35	0.00 ± 0.20	Angles ± 3'
				UNIT: mm		

Central Components Manufacturing
 440 Lincoln Blvd., Middlesex, New Jersey 08846
 Phone 732 469-5720 888 288-5152 Fax 732 469-1919

Part No.: **BRS-02-XXW-XX-XX-SM-CP-XXX**

Description: Receptacle strip, double row, .079" (2.00mm) pitch, top entry, surface mount

Grid coordinates: 1-9 (horizontal), A-G (vertical)