

### Recommended P.C. Board SMD Layout

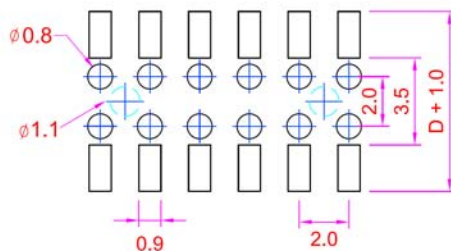

**SPECIFICATIONS.**  
 Current Rating: 2 Amps  
 Insulator Resistance: 1000 Megohms min.  
 Contact Resistance: 20 m ohms max.  
 Contact Material: Phosphor Bronze  
 Insulator Material: Polyester, UL94V-0 Nylon 6-T  
 Contact Plating: Gold Flash, std  
 Withstanding: 500VAC  
 Operating Temp: -40C ~ +105C

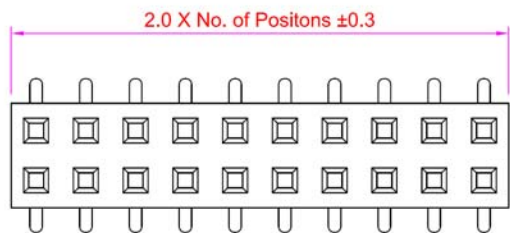
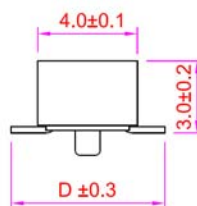
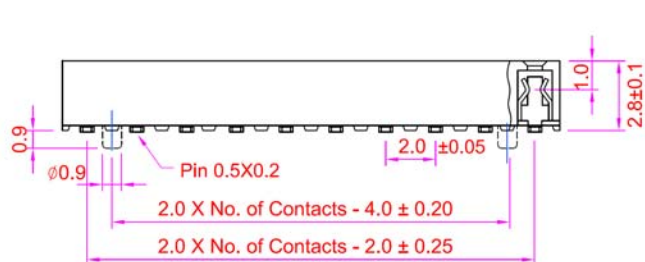

Series	Rows	Profile	Positions	Tail Spacing	Plating	Option 1	Option 2	Option 3
BRS	XX	BELPG	XX	F	XX	SM	CAP	Package
2mm Receptacle Strip	01=Single 02=Double	2.8mm Bottom Entry	Single Row=01-40 Double Row=04-80	F=5.4mm G=6.2mm	TN=Tin SGXX=Selective Gold GDXX=Gold (std) XX=Flash if blank, 10,15,30u"	SM=Surface Mount CP=Centering Peg	TB=Tube TR=Reel	Blank=none P=Plastic M=Metal F=Film

**RoHS compliant**

Rev.	Description	Date	Approved	Drawing	Name	Date
				Approved	Howard	04/17/15
				Checked	Lizzy	04/17/15
				Drawn	Tina	04/17/15
				0.0 ± 0.35	0.00 ± 0.20	Angles ± 3'
				UNIT: mm		

**Central Components Manufacturing**  
 440 Lincoln Blvd., Middlesex, New Jersey 08846  
 Phone 732 469-5720 888 288-5152 Fax 732 469-1919

Part No.: **BRS-02-BELPG-XX-X-XX-SM-XX**

Description: Female Header 2.3mm Bottom Entry, Dual Row SMD