

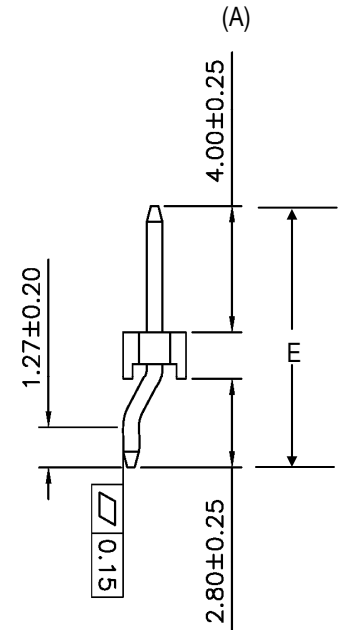

**SPECIFICATIONS**  
 Current Rating: 2 Amp  
 Contact Material: Brass  
 Contact Resistance: 20mΩ Max.  
 Insulation Material: Polyester, UL94V-0  
 Insulation Resistance: 1000MΩ Min.  
 Withstanding: 500V AC  
 Operating Temp: -40°C to +105°C

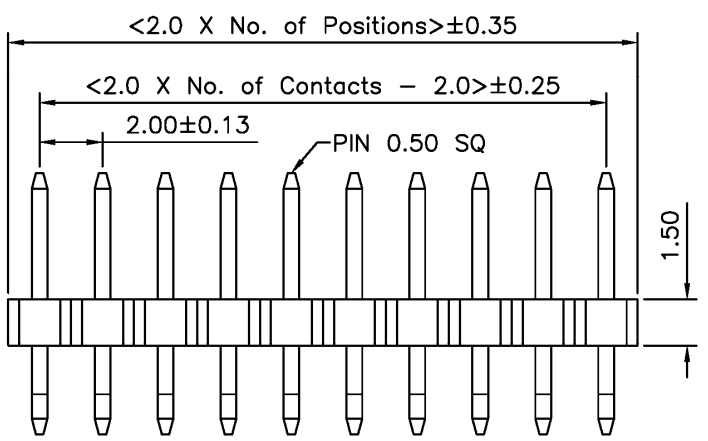

Recommended P.C.Board Layout

(Tolerance:  $\pm 0.05$ )

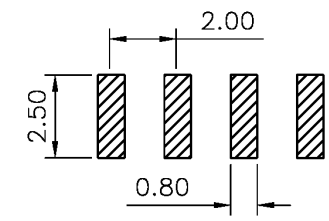

**RoHS compliant**

Series	Insulator	Rows	Type	Positions	Contact Length	Plating	Options
BPH	X	X	XX	XX	XXX	XX	XX
2mm Unshrouded Pin Headed	Blank=.079 (2.0mm) C=.059 (1.5mm)	1,2	Blank=Straight RA=Right Angle RRA=Reverse Right Angle SM=Surface Mount RASM=R/A Surface Mount	Single Row: 1-40 Double Row: 2-80	SD=.157 (4mm) Mating CSL=(A/E)	GD=Gold SG=Selective Gold TN=Tin	Blank=None PPL=Pick & Place Pad TR=Tape & Reel TB=-Tube

Rev.	Description	Date	Approved	Drawing	Name	Date
				Approved	Howard	12/12/08
				Checked	Lizzy	12/12/08
				Drawn	Tina	12/12/08
				0.0 ± 0.35	0.00 ± 0.20	Angles ± 3'
				UNIT: mm		

**Central Components Manufacturing**  
 440 Lincoln Blvd., Middlesex, New Jersey 08846  
 Phone 732 469-5720 888 288-5152 Fax 732 469-1919

Part No.: **BPH-C-1-RASM-XX-SD-XX-XX**  
 Description: 2.00 Pin Header Single Row SMT Type Base 1.50H

