

RECOMMEND PCB LAYOUT

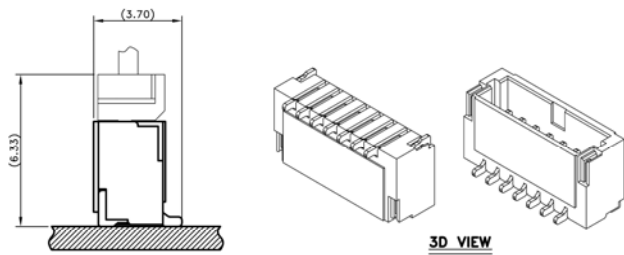

ASSEMBLED ALL PART VIEW

3D VIEW

SPECIFICATIONS
 Voltage Rating: 50VAC/VDC
 Current Rating: 1 amp AC/DC
 Contact Material: Phosphor Bronze
 Contact Plating: Tin or Gold
 Contact Resistance: 20 milliohms max.
 Base Material: Polyamide 9T, UL94V-0
 Insulation Resistance: 100 megohms min.
 Withstanding: 500VAC for 1 min.
 Temperature Range: -25°C to +85°C
 Quantity: 1,000 pcs/tube
 1,000 pcs/reel w/cap

Mates with JS-CH-1253

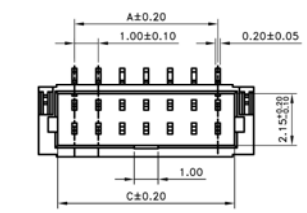

ASSEMBLED CAP VIEW

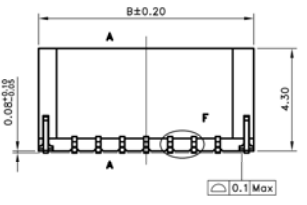
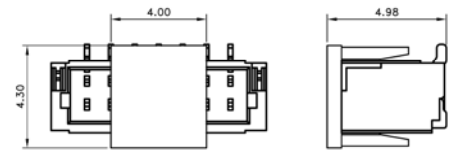

DETAIL F (SCALE 2:1)

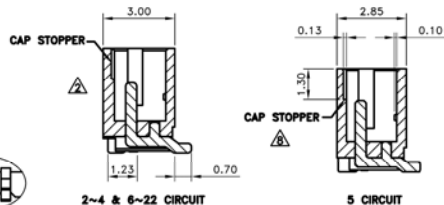

SECTION A-A

Dimensions							
Poles	A	B	C	Poles	A	B	C
2	1.00	4.00	2.45	13	12.00	15.00	13.45
3	2.00	5.00	3.45	14	13.00	16.00	14.45
4	3.00	6.00	4.45	15	14.00	17.00	15.45
5	4.00	7.00	5.45	16	15.00	18.00	16.45
6	5.00	8.00	6.45	17	16.00	19.00	17.45
7	6.00	9.00	7.45	18	17.00	20.00	18.45
8	7.00	10.00	8.45	19	18.00	21.00	19.45
9	8.00	11.00	9.45	20	19.00	22.00	20.45
10	9.0	12.00	10.45	21	20.00	23.00	21.45
11	10.00	13.00	11.45	22	21.00	24.00	22.45
12	11.00	14.00	12.45				

Series	Type	Positions	Plating
JS-CH	1254	XX	XX
Pluggable Connectors	1254=Vertical SMT Wafer 1254R=R/A SMT Wafer	02-22 See Chart	Blank=Tin GD=Gold

RoHS compliant

Rev.	Description	Date	Approved	Drawing	Name	Date
				Approved	Howard	09/26/07
				Checked	Lizzy	09/26/07
				Drawn	Tina	09/26/07
				0.0 ± 0.35	0.00 ± 0.20	Angles ± 3'
				UNIT: mm		

Central Components Manufacturing
 440 Lincoln Blvd., Middlesex, New Jersey 08846
 Phone 732 469-5720 888 288-5152 Fax 732 469-1919

Part No.: **JS-CH-1254-XX-XX**

Description: 1.00mm Crimp Style Connector, SMT Straight