

**SPECIFICATIONS**

Current rating: 1 amp  
 Contact material: Phosphor bronze  
 Contact plating: Tin 120μ"  
 Housing material: PPS or Nylon  
 Insulation resistance: 10,000 megohms min.  
 Insertion force: 200g  
 Durability: 40 cycles min.  
 Operating temperature: -55°C to +105°C

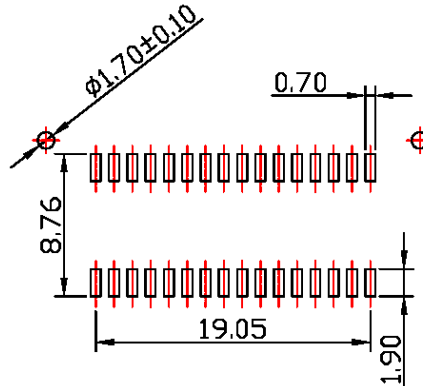
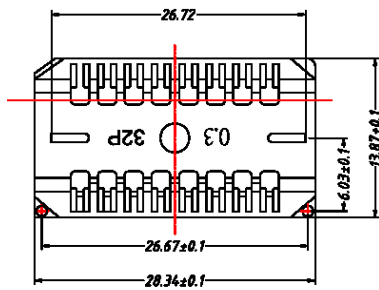

PCB Layout

RoHS compliant

Series	Type	Positions	Plating	Options
CSJ	X	XX	XX	XX
SOJ socket	A=.300" chip width B=.400" chip width	20, 24, 26, 28, 32, 40, 42	TN=Tin GD=Gold	[blank]=None PP=Polarized NY=Nylon material LC=LC P material

Rev.	Description	Date	Approved	Drawing	Name	Date
				Approved	Howard	08/10/99
				Checked	Lizzy	08/10/99
				Drawn	Tina	08/10/99
				0.0 ± 0.35	0.00 ± 0.20	Angles ± 3'
				UNIT: mm		

**Central Components Manufacturing**  
 440 Lincoln Blvd., Middlesex, New Jersey 08846  
 Phone 732 469-5720 888 288-5152 Fax 732 469-1919

Part No.: **CSJ-A-32-XX-XX**

Description: SOJ surface mount socket