

**SPECIFICATIONS**

Current rating: 3 amps  
 Contact material: Phosphor bronze  
 Contact resistance: 20 milliohms max.  
 Contact plating: Tin, gold or duplex  
 Insulator material: PBT, UL94V-0  
 Insulator resistance: 5,000 megohms min.  
 Withstanding: 500VAC for 1 min.  
 Operating temperature: -40°C to +105°C

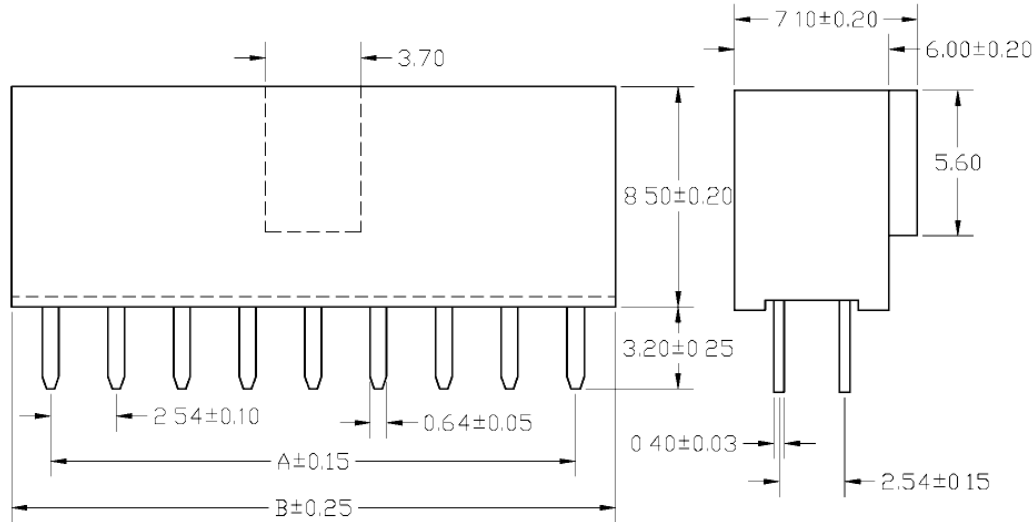

**Recommended PC Board Layout  
(PCB tolerance ±0.05)**

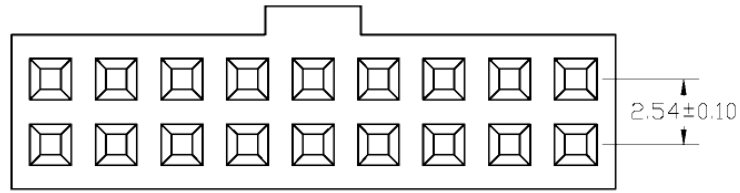
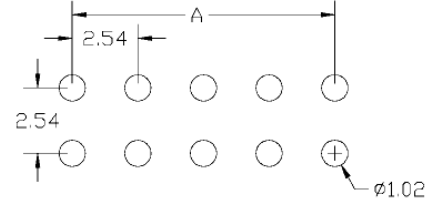

A=(No. Pos./2)-1x2.54  
 B=A+3.04

Series	Rows	Type	Contacts	Plating	Options
ARS	XX	XX	XX	XX	XX
Receptacle strip	01=Single row 02=Dual row 03=Single row right angle 04=Dual row right angle	[blank]=Top Entry DE=Dual entry BE=Bottom entry SE=Side entry	Single row: 3-36 Dual row: 6-72	TN=Tin GDXX=Gold SGXX=Selective Gold XX=Flash if blank 10,15,30u"	[blank]=None SM=Surface mount RT=Retention tails P=Polarized HT=High Temp

RoHS compliant

Rev.	Description	Date	Approved	Drawing	Name	Date
				Approved	Howard	08/10/99
				Checked	Lizzy	08/10/99
				Drawn	Tina	08/10/99
				0.0 ± 0.35	0.00 ± 0.20	Angles ± 3'
				UNIT: mm		

**Central Components Manufacturing**  
 440 Lincoln Blvd., Middlesex, New Jersey 08846  
 Phone 732 469-5720 888 288-5152 Fax 732 469-1919

Part No.: **ARS-02-XX-XX-XX-P1**

Description: Receptacle strip, .100" pitch, dual row, polarized