

SPECIFICATIONS
 Housing Material: Nylon 6T +30% G.F. UL94V-0, Black
 Contact Material: Phosphor Bronze
 Cap Material: Steel

RECOMMENDED P.C.BOARD HOLE LAYOUT

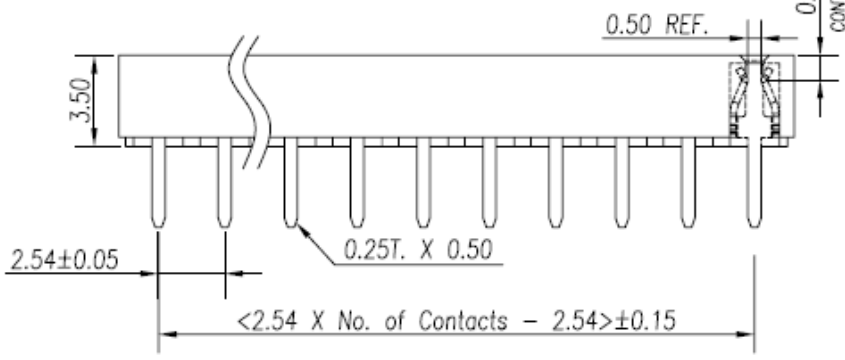
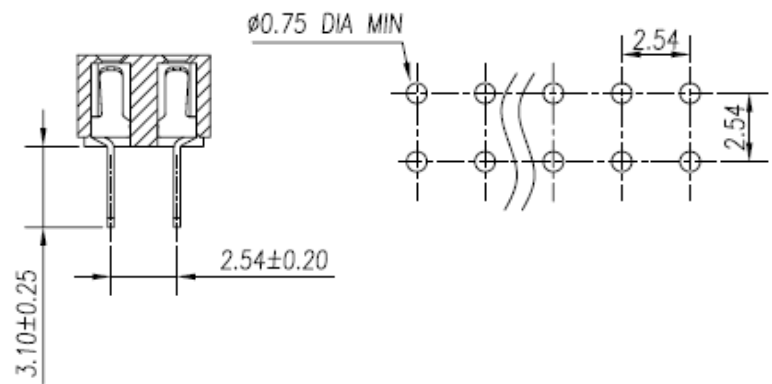

Series	Rows	Profile	Contacts	Plating	Options
ARS	XX	LPX	XX	XX	XX
Receptacle strip	01=Single row 02=Dual row 03=Single row right angle 04=Dual row right angle	[blank]=8.5mm LPE=3.5mm	Single row: 2-40 Dual row: 4-80	TN=Tin GDXX=Gold, SGXX=Selective Gold XX=Flash if blank (std) 10,15,30u"	[blank]=None SM=Surface mount RT=Retention tails P=Polarized HT=High Temp TR=Reel

RoHS compliant

Rev.	Description	Date	Approved	Drawing	Name	Date
				Approved	Howard	5/28/08
				Checked	Lizzy	5/28/08
				Drawn	Tina	5/28/08
				0.0 ± 0.35	0.00 ± 0.20	Angles ± 3°
				UNIT: mm		

Central Components Manufacturing
 440 Lincoln Blvd., Middlesex, New Jersey 08846
 Phone 732 469-5720 888 288-5152 Fax 732 469-1919

Part No.: **ARS-02-LPE-XX-XX**

Description: 2.54 Female Header Dual Rows SMT Type