

| acetate tape | NOTE     |
|--------------|----------|
| 5.1mm        | 02~08PIN |
| 10mm         | 09~40PIN |

**SPECIFICATIONS**

Current Rating: 3Amp  
 Contact Material: Phosphor Bronze  
 Contact Resistance: 20mΩ Max.  
 Insulation Material: Nylon 6T High Temp  
 Insulation Resistance: 1000MΩ Min.  
 Withstanding: 600V AC  
 Durability: 2500 Cycles min.  
 Processing Temp: 260°C, 10 sec  
 Operating Temp: -40°C to +105°C

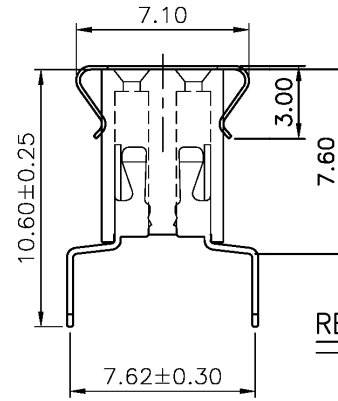
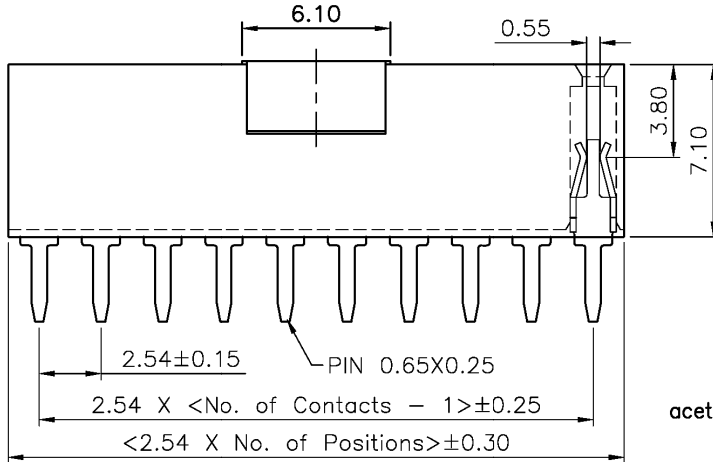

**RECOMMENDED P.C.B LAYOUT**  
(Tolerance: ±0.05)

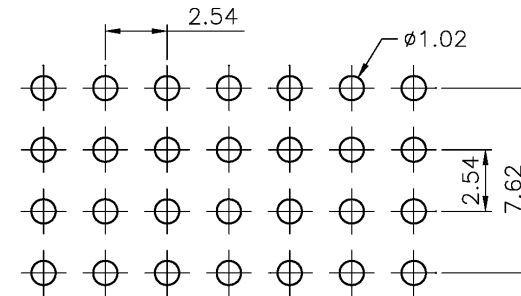

**RoHS compliant**

| Series                      | Rows         | Style/Profile                                      | Positions | Plating                                | Options   |
|-----------------------------|--------------|--|-----------|--|---|
| ARS                         | 02           | BELPB  | XX        | XX                                     | XX  |
| .100 pitch receptacle strip | 02=dual rows | BELPB=Bottom entry 7.1mm height (Others Available) | 04-80     | TN=Tin<br>SG=Selective Gold<br>GD=Gold | PPL=Pick & Place Cap<br>PPT=Pick & Place Tape<br>TR=Tape & Reel |

| Rev. | Description | Date | Approved | Drawing    | Name        | Date        |
|------|-------------|------|----------|------------|-------------|-------------|
|      |             |      |          | Approved   | Howard      | 08/04/08    |
|      |             |      |          | Checked    | Lizzy       | 08/04/08    |
|      |             |      |          | Drawn      | Tina        | 08/04/08    |
|      |             |      |          | 0.0 ± 0.35 | 0.00 ± 0.20 | Angles ± 3' |
|      |             |      |          | UNIT: mm   |             |             |

**Central Components Manufacturing**  
 440 Lincoln Blvd., Middlesex, New Jersey 08846  
 Phone 732 469-5720 888 288-5152 Fax 732 469-1919

Part No.: **ARS-02-BELPB-XX-XX-XX**

Description: 2.54 Female Header Dual Rows DIP Type Connector