

**Recommended
P.C. Board Hole Layout**

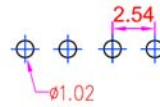

SPECIFICATIONS

Current Rating:	3 Amps
Insulator Resistance:	1000 Megohms Min.
Contact Resistance:	20m ohms max.
Withstanding:	AC 600V
Contact Material:	Brass
Insulator Material:	Polyester, UL94V-0 PBT
Contact Plating:	Gold Flash (std)
Operating Temp:	-40C ~ +105C

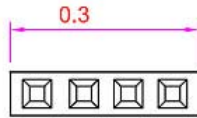
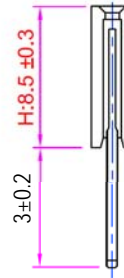
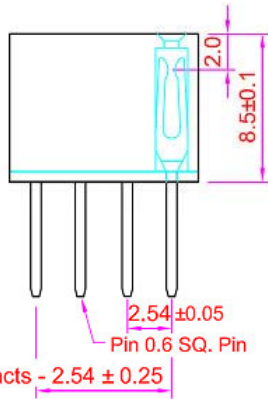

2.54 X No. of ontacts - 2.54 ± 0.25

RoHS compliant

Rev.	Description	Date	Approved	Drawing	Name	Date
				Approved	Howard	10/29/14
				Checked	Lizzy	10/29/14
				Drawn	Tina	10/29/14
				0.0 ± 0.35	0.00 ± 0.20	Angles ± 3'
						UNIT: mm

Central Components Manufacturing
 440 Lincoln Blvd., Middlesex, New Jersey 08846
 Phone 732 469-5720 888 288-5152 Fax 732 469-1919

Part No.: **ARS-01-04-GD**

Description: Female straight pin header, .100" pitch, 4 position