

inches  
mm

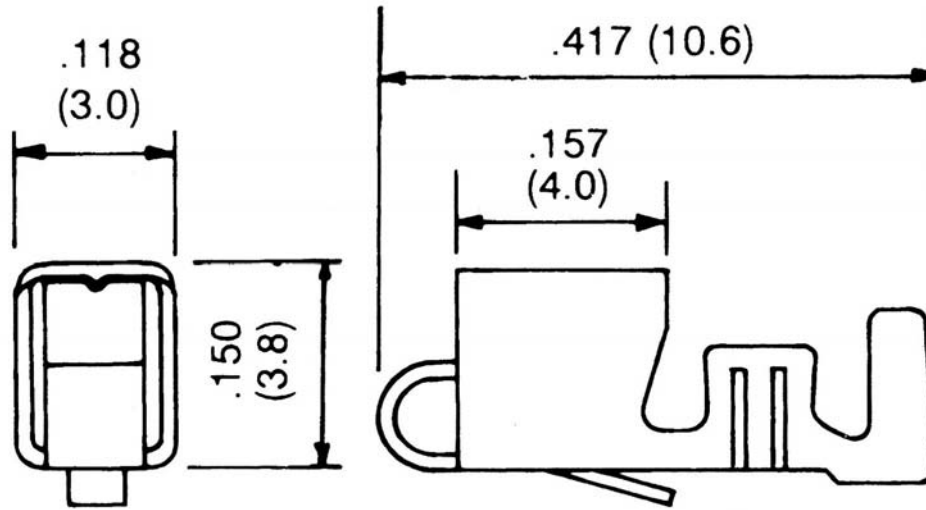

**SPECIFICATIONS**

Voltage rating: 250VAC/VDC  
 Current rating: 7 amps AC/DC  
 Contact material: Brass  
 Contact plating: Tin  
 Contact resistance: 10 milliohms max. initial  
 20 milliohms max. after environmental testing  
 Withstanding: 1,500 VAC for 1 min.  
 Applicable wires: AWG#22-18  
 Insulation OD: .067" (1.7mm) to .118" (3.0mm)  
 Used in: JS-A-9396-XX series housing

RoHS compliant

Rev.	Description	Date	Approved	Drawing	Name	Date
				Approved	Howard	11/30/07
				Checked	Lizzy	11/30/07
				Drawn	Tina	11/30/07
				0.0 ± 0.35	0.00 ± 0.20	Angles ± 3'
						UNIT: mm

**Central Components Manufacturing**  
 440 Lincoln Blvd., Middlesex, New Jersey 08846  
 Phone 732 469-5720 888 288-5152 Fax 732 469-1919

Part No.: **JS-A-96T**

Description: Terminal for JS-A-9396-XX series housing,  
 .156" (3.96mm) pitch, for use in medium current applications